

Note to Designer:
 The information presented in this Standard Detail has been prepared in accordance with recognized engineering principles and is for general use. It should not be used for specific application without competent professional examination and verification of its suitability and applicability by a licensed professional engineer. Contents within the inner border line shall not be altered.

NO.	DESCRIPTION OF REVISIONS	DATE	MADE BY	DATE	BY
1	Original Issue	9-10	SJH		
2					
3					
4					

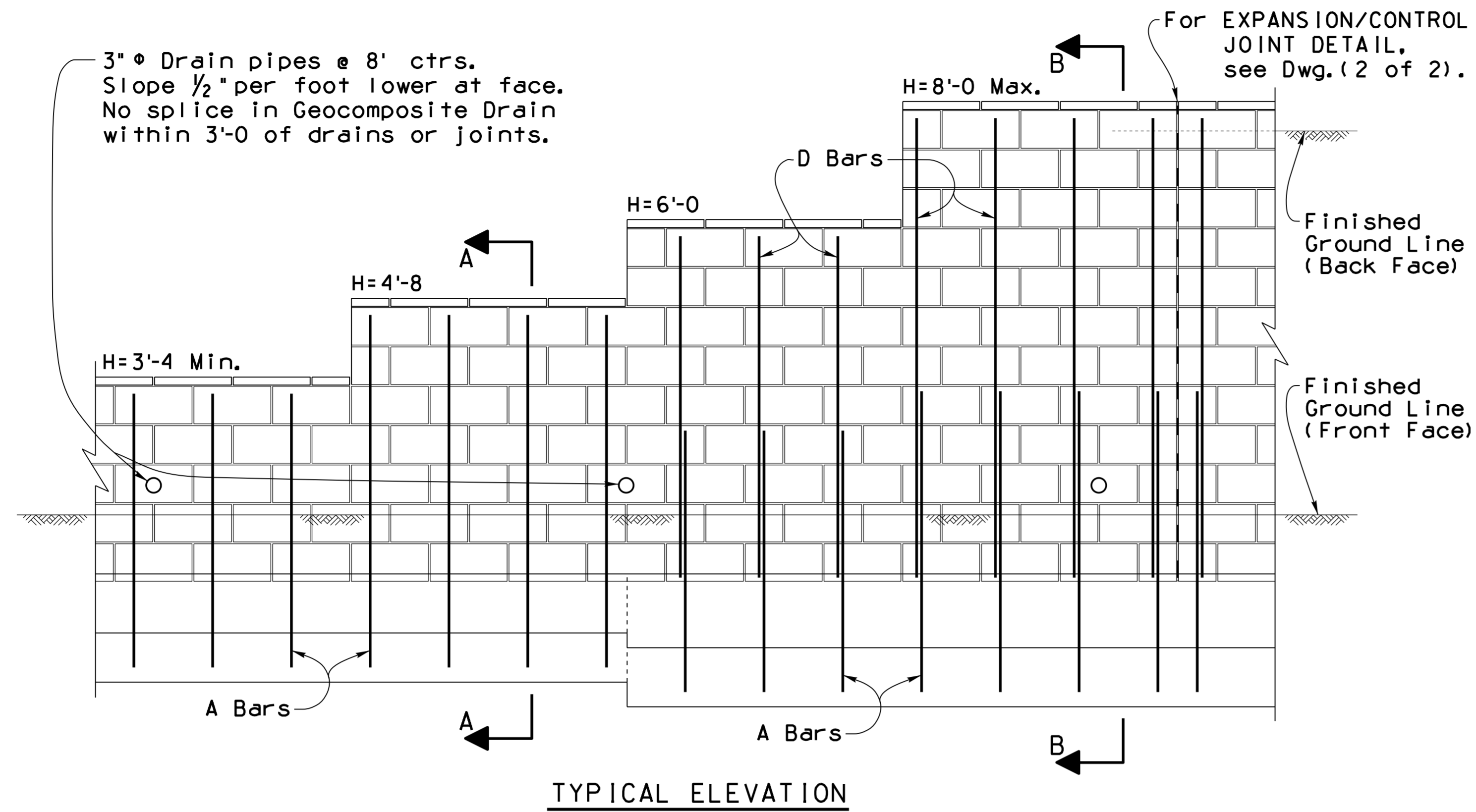

NOTE:
 For STRUCTURAL EXCAVATION LIMITS and STRUCTURE BACKFILL LIMITS, See Dwg. (2 of 2).

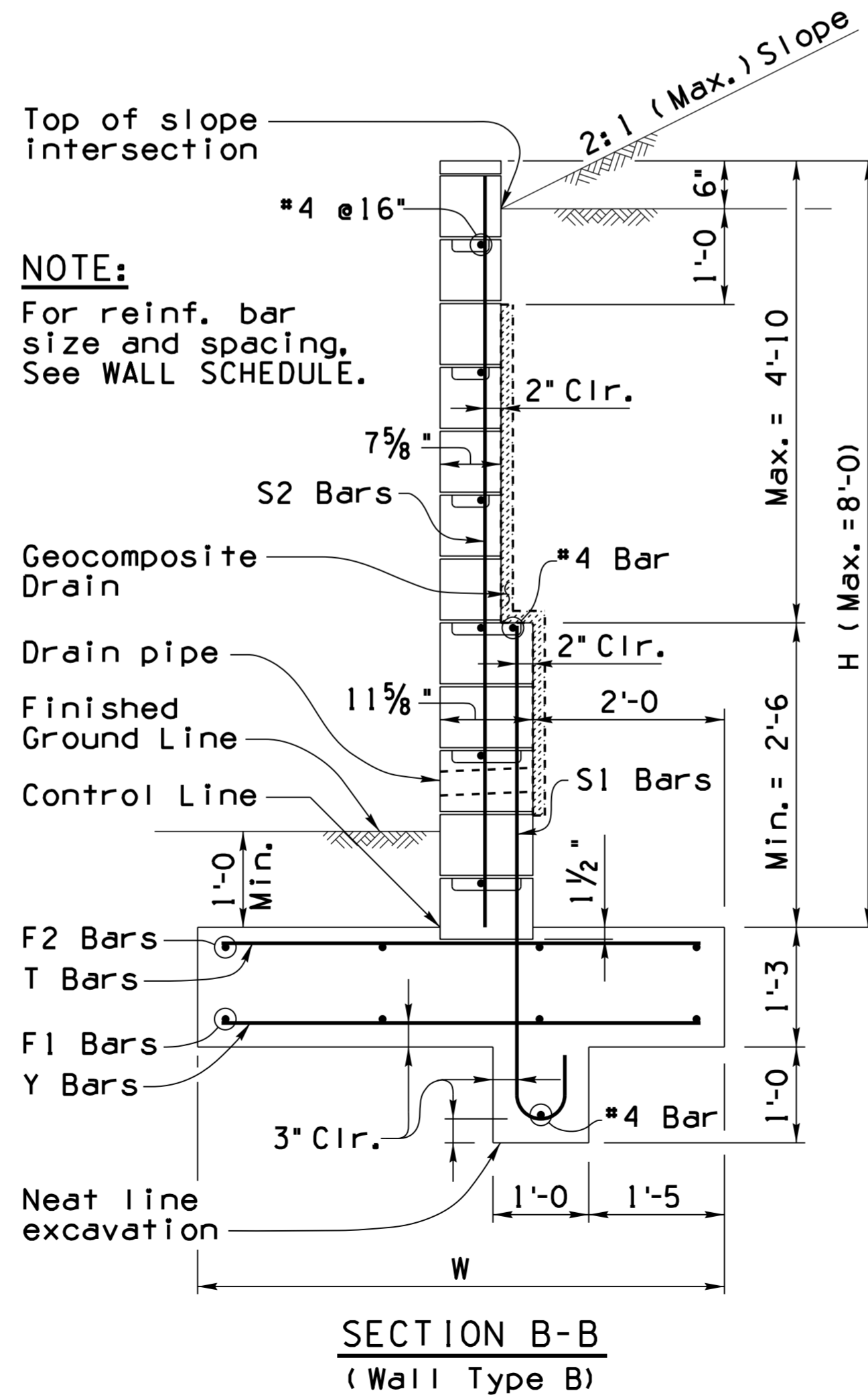
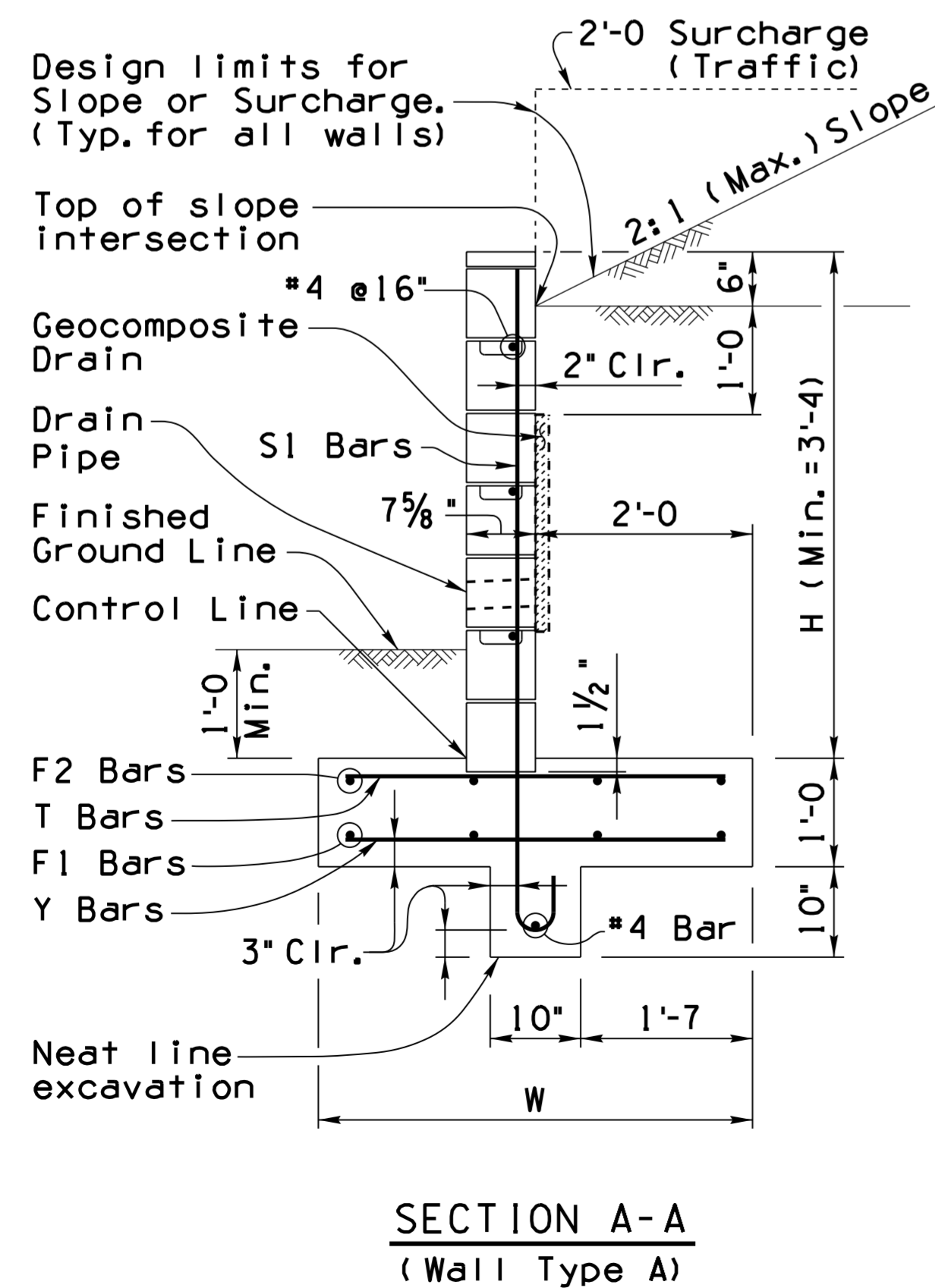

NOTE:
 For reinf. bar size and spacing, See WALL SCHEDULE.

WALL SCHEDULE									
Wall Height H	Wall Type	Ftg. Width W	Reinforcing Steel*					Factored Average Soil Bearing Pressure (psf)	
			Wall, Vertical	Footing					
			S1	S2	F2	T	F1	Y	
3'-4 to 4'-0	A	3'-6	*4@16"	-	4-*4	*4@16"	-	-	1700
4'-4 to 5'-0	A	4'-0	*5@16"	-	4-*4	*4@16"	4-*4	*4@16"	1800
5'-4 to 6'-0	B	4'-6	*5@16"	*4@16"	4-*5	*4@16"	4-*5	*4@16"	1900
6'-4 to 7'-0	B	5'-0	*6@16"	*4@16"	4-*5	*5@16"	4-*5	*5@16"	2100
7'-4 to 8'-0	B	5'-6	*7@16"	*5@16"	4-*5	*6@16"	4-*5	*6@16"	2300

* Additional Reinforcement required at Control Joints.

GENERAL NOTES:
 Construction Specification - Arizona Department of Transportation Standard Specifications for Road and Bridge Construction, latest Edition, ACI 530.1, Specifications for Masonry Structures.

Design Specifications - AASHTO LRFD Bridge Design Specifications, 5th Edition 2010.

Design:
 Soil weight = 120 pcf
 Backfill angle of internal friction = 33°
 Existing ground angle of internal friction = 30°

Masonry shall meet the Materials Notes requirements. All block cells shall be filled with concrete. For wall surface treatment and type of block, see Project Plans.

All Concrete shall be Class "S" (f'c = 3000 psi).

Reinforcing steel shall conform to ASTM Specification A615. All reinforcing shall be furnished as Grade 60.

All bends and hooks shall meet the requirements of AASHTO LRFD Article 5.10. All bend dimensions for reinforcing steel shall be out-to-out of bars. All placement dimensions for reinforcing steel shall be to center of bars unless noted otherwise.

All reinforcing steel shall have 2 inch clear cover unless noted otherwise.

Compact backfill for footing and wall base minimum 95 percent of ASTM D698 maximum dry density.

Dimensions shall not be scaled from drawings.

Pay item is measured as wall height H times length of wall, and pay item includes all labor and materials for excavation, backfill, drainage, concrete footing and masonry wall with reinforcements.

Item No. 9140179 RETAINING WALL (MASONRY CANTILEVER)
 Measure: Square Foot

(GENERAL NOTES Continued on Dwg. 2 of 2)

NOTE:
 For General Notes (Continued) and Details see SD 7.02 (2 of 2).

DESIGN APPROVED <i>Shafiq U. Hasan</i>		ARIZONA DEPARTMENT OF TRANSPORTATION INFRASTRUCTURE DELIVERY AND OPERATIONS DIVISION BRIDGE GROUP STRUCTURE DETAIL	
APPROVED FOR DISTRIBUTION <i>Teon A. Nehme</i>		RETAINING WALL (MASONRY CANTILEVER)	
ROUTE	PROJECT NO.	FA NO.	DRAWING NO. SD 7.02 (1 of 2)
LOCATION			SHEET NO. OF