

BEGIN R/W PROJECT
202L MA 003 H5380 01R
RAM 600-7-802

EXISTING CITY/COUNTY R/W

TYPE	BK./DKT.	PAGE	WIDTH	YEAR
WD	86-035447	-	VARIABLES	1986
FOC	86-208131	-	VARIABLES	1986
ESMT	91-340010	-	VARIABLES	1991
ESMT	1	23	66'	1917
ESMT	1	41	66'	1916
ESMT	1	42	66'	1916
ESMT	1	59	66'	1919
ESMT	1	30	VARIABLES	1987
ESMT	117	606	33'	1917
ESMT	6091	66	22'	1966

HELPFUL HINTS
Don't fill in the Data Fields on the Quarter corners & Section corners for the Vicinity Map.

Found Section

Unfound Section

HELPFUL HINTS
Sixteenth lines are not normally shown on the vicinity map. Government Lots will be shown with their lots numbers and GLO Lot Lines.

HELPFUL HINTS
Only show road limits in recorded subdivisions. Do not show subdivision road names or lot lines unless directed by ADOT.

HELPFUL HINTS
NOTE: All parameters shown on this sheet are relative to the plan scale of 1"=500'

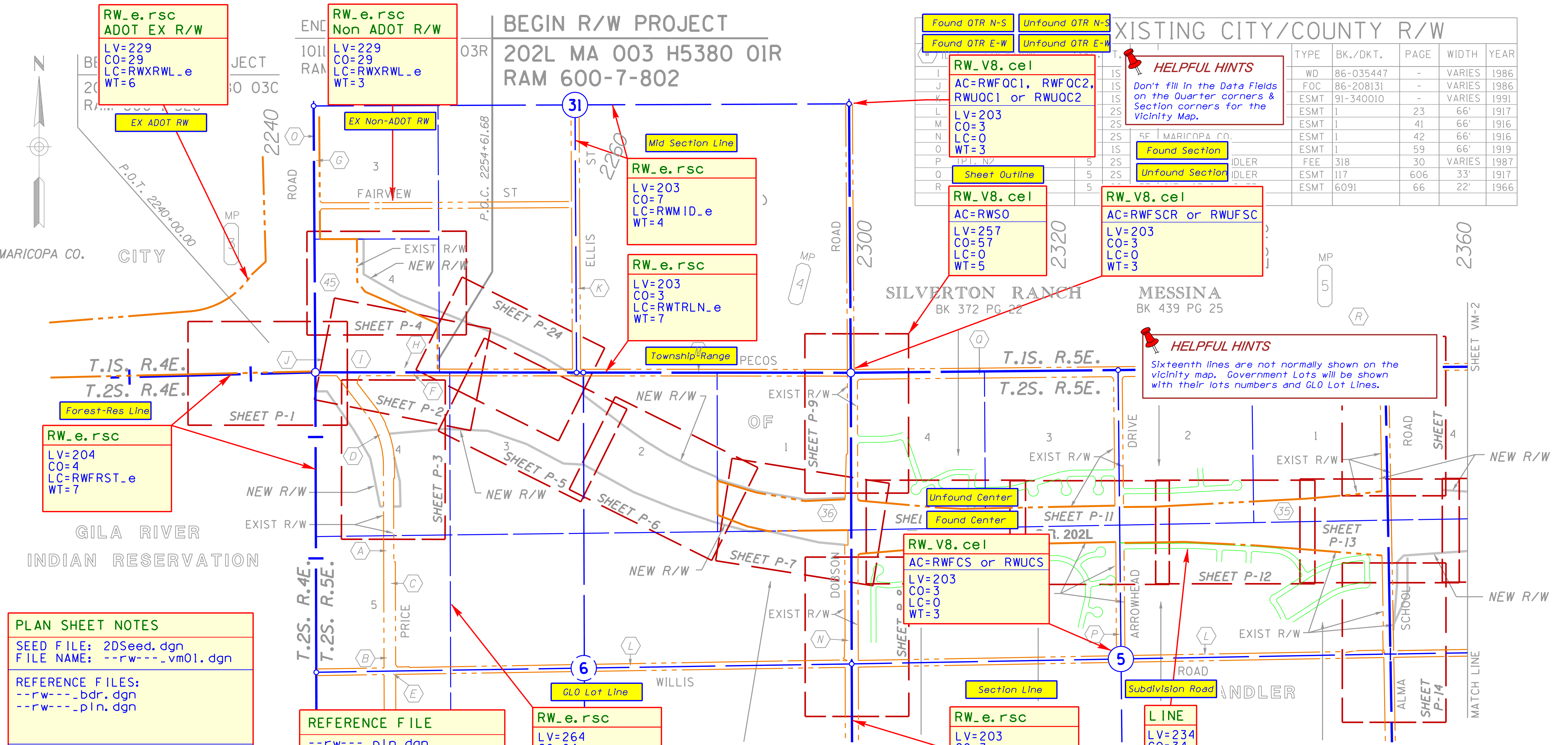

PLAN SHEET NOTES
SEED FILE: 2DSeed.dgn
FILE NAME: --rw---_vm01.dgn

REFERENCE FILES:
--rw---_bdr.dgn
--rw---_pln.dgn

AA=0 AS=5 RV=As needed
See plotting instructions in CADD Standards Manual for additional details.

REFERENCE FILE
--rw---_pln.dgn
Attachment: Coincident

All notes on this sheet relate to the above reference file.

36	PT. LOT 1	6	2S	5E	MINISTRY RESOURCE	WD	99-0384000	VARIABLES	1997	7-8061
45	PT. LOT 4	31	1S	5E	PRICE & PECOS CORP.	WD	92-0236425	VARIABLES	1999	7-8535
								VARIABLES	1999	7-8507
								VARIABLES	1992	7-7097

INDEX TO EXISTING CITY/COUNTY R/W

ID.	LOCATION	SEC.	T.	R.	ACQ. FROM	TYPE	BK./DKT.	PAGE	WIDTH	YEAR
A	PT. SW4 & NW4	6	2S	5E	ALLAN E. SLATIN ET AL	FOC	86-268029	-	VARIABLES	1986
B	PT. SW4 & NW4	6	2S	5E	NORMA ASHELY	FOC	86-560784	-	VARIABLES	1986
C	PT. SW4 & NW4	6	2S	5E	PRODUCERS COTTON	FOC	87-031743	-	VARIABLES	1987
D	PT. NW4	6	2S	5E	HASKLE PARTNERSHIP	FOC	87-049488	-	VARIABLES	1987
E	PT. SW4 & NW4	6	2S	5E	CENTRAL INVESTMENT	FOC	87-157343	-	VARIABLES	1987
F	PT. LOT 3	6	2S	5E	PRICE & PECOS CORP.	ESMT	91-323608	-	VARIABLES	1991
G	PT. LOT 3 & 4	31	1S	5E	STEWART TITLE	OCD	14149	1119	VARIABLES	1980
H	PT. LOT 4	31	1S	5E	STEWART TITLE	OCD	14149	1115	VARIABLES	1980

* - Refers to item number in Existing R/W report dated 4/13/00

C.O. NO.	DATE	BY	DESCRIPTION OF REVISIONS
9439	1-25-01	JC	Decreased New R/W Lt Sta 2351+20

DRAWING NO.	D-7-T-909	ARIZONA DEPARTMENT OF TRANSPORTATION INTERMODAL TRANSPORTATION DIVISION RIGHT OF WAY PLANS SECTION	PRELIMINARY NOT FOR CONSTRUCTION OR RECORDING --Created-- 9/9/2009 8:44:39 AM
SURVEY	ER 8941 MI		
DRAWN/DATE	J. Crume/Sep 01	HIGHWAY NAME:	SANTAN FREEWAY
ADOT REVIEW	B. Gurney	FEDERAL AID NO.:	RAM 600-7-802
HUBBARD ENGINEERING 480-892-3313 Gilbert, AZ jcrume@hbeaz.us Job # 20047	PROJECT NO.:	202L MA 003 H5380 01R	
ROUTE NO.:	SR 202L	LOCATION:	Price Road - Arizona Avenue
SHEET			VM-1

VICINITY MAP
EXHIBIT-D2
(URBAN)
ADOT CADD STANDARDS 2006



Scale
exhibitD2_vm01.dgn