

# RESULTS OF SURVEY

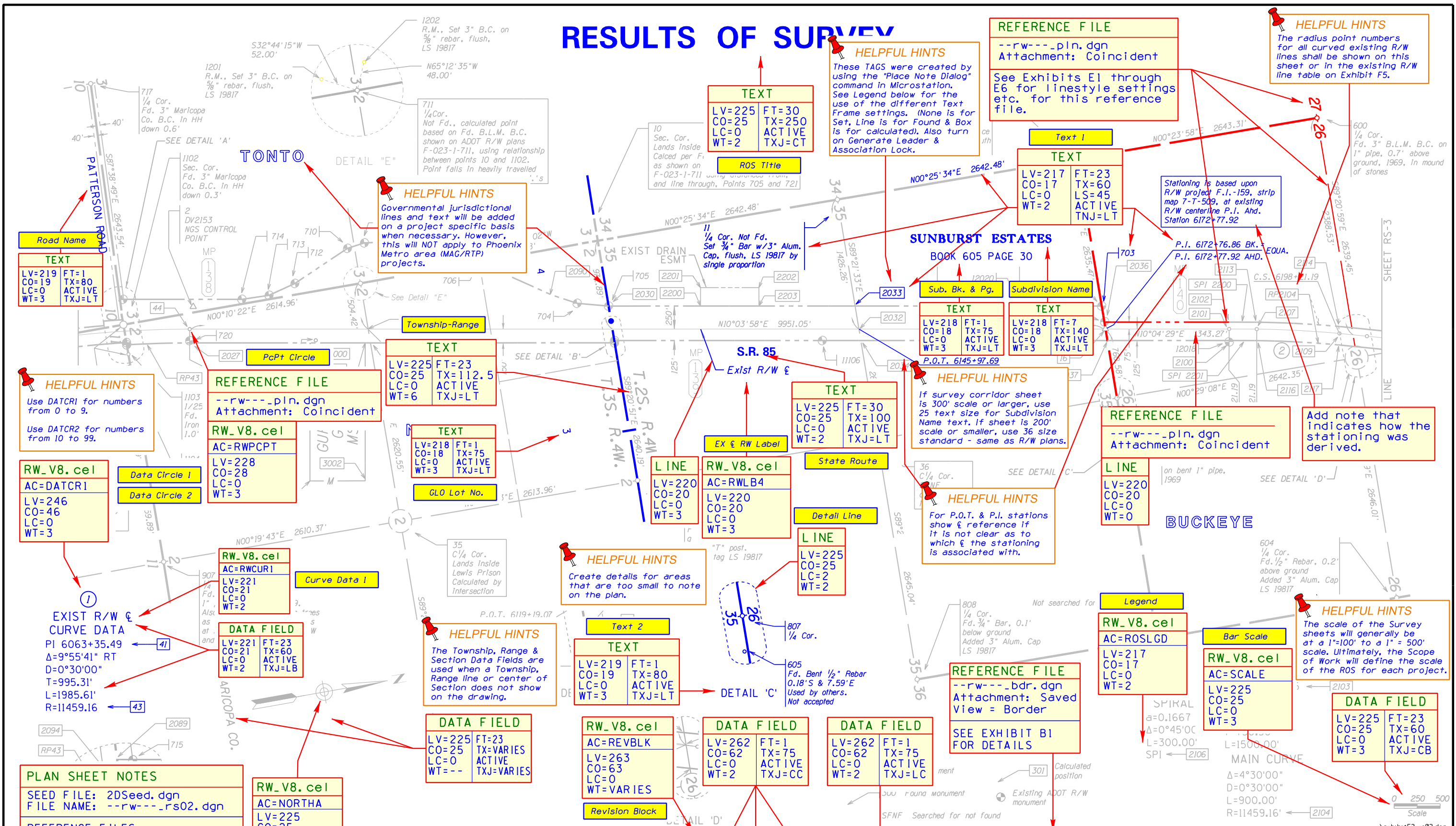

**Road Name**

TEXT  
LV=219 FT=1  
CO=19 TX=80  
LC=0 ACTIVE  
WT=3 TXJ=LT

**HELPFUL HINTS**  
Use DATCR1 for numbers from 0 to 9.  
Use DATCR2 for numbers from 10 to 99.

**RW\_V8. cel**  
AC=DATCR1  
LV=246  
CO=46  
LC=0  
WT=3

**REFERENCE FILE**  
--rw---\_pin.dgn  
Attachment: Coincident

**RW\_V8. cel**  
AC=RWPCPT  
LV=228  
CO=28  
LC=0  
WT=3

**RW\_V8. cel**  
AC=RWCURI  
LV=221  
CO=21  
LC=0  
WT=2

**DATA FIELD**  
LV=221 FT=23  
CO=21 TX=60  
LC=0 ACTIVE  
WT=2 TXJ=LB

**PLAN SHEET NOTES**  
SEED FILE: 2DSeed.dgn  
FILE NAME: --rw---\_rs02.dgn  
  
REFERENCE FILES:  
--rw---\_bdr.dgn  
--rw---\_pin.dgn  
  
AA=0 AS=5 RV=As needed  
See plotting instructions in CADD Standards Manual for additional details.

**RW\_V8. cel**  
AC=NORTHA  
LV=225  
CO=25  
LC=0  
WT=1

**North Arrow**

Also See Exhibits F6 & F7 for additional notes and parameters.

**HELPFUL HINTS**  
Governmental jurisdictional lines and text will be added on a project specific basis when necessary. However, this will NOT apply to Phoenix Metro area (MAG/RTP) projects.

**TEXT**  
LV=225 FT=23  
CO=25 TX=112.5  
LC=0 ACTIVE  
WT=6 TXJ=LT

**TEXT**  
LV=218 FT=1  
CO=18 TX=75  
LC=0 ACTIVE  
WT=3 TXJ=LT

**GLO Lot No.**

**HELPFUL HINTS**  
Create details for areas that are too small to note on the plan.

**Text 2**

TEXT  
LV=219 FT=1  
CO=19 TX=80  
LC=0 ACTIVE  
WT=3 TXJ=LT

**DATA FIELD**  
LV=225 FT=23  
CO=25 TX=VARIES  
LC=0 ACTIVE  
WT=--- TXJ=VARIES

**RW\_V8. cel**  
AC=REVBLK  
LV=263  
CO=63  
LC=0  
WT=VARIES

**Revision Block**

**TEXT**  
LV=225 FT=30  
CO=25 TX=250  
LC=0 ACTIVE  
WT=2 TXJ=CT

**ROS Title**

**TEXT**  
LV=225 FT=30  
CO=25 TX=100  
LC=0 ACTIVE  
WT=2 TXJ=LT

**L LINE**  
LV=220  
CO=20  
LC=0  
WT=3

**RW\_V8. cel**  
AC=RWLBA  
LV=220  
CO=20  
LC=0  
WT=3

**DATA FIELD**  
LV=262 FT=1  
CO=62 TX=75  
LC=0 ACTIVE  
WT=2 TXJ=CC

**DATA FIELD**  
LV=262 FT=1  
CO=62 TX=75  
LC=0 ACTIVE  
WT=2 TXJ=LC

**HELPFUL HINTS**  
These TAGS were created by using the "Place Note Dialog" command in Microstation. See Legend below for the use of the different Text Frame settings. (None is for Set, Line is for Found & Box is for calculated). Also turn on Generate Leader & Association Lock.

**REFERENCE FILE**  
--rw---\_pin.dgn  
Attachment: Coincident

See Exhibits E1 through E6 for linestyle settings etc. for this reference file.

**Text 1**

TEXT  
LV=217 FT=23  
CO=17 TX=60  
LC=0 LS=45  
WT=2 ACTIVE  
TNJ=LT

**SUNBURST ESTATES**  
BOOK 605 PAGE 30

**Sub. Bk. & Pg.**

TEXT  
LV=218 FT=1  
CO=18 TX=75  
LC=0 ACTIVE  
WT=3 TXJ=LT

**Subdivision Name**

TEXT  
LV=218 FT=7  
CO=18 TX=140  
LC=0 ACTIVE  
WT=3 TXJ=LT

**HELPFUL HINTS**  
If survey corridor sheet is 300' scale or larger, use 25 text size for Subdivision Name text. If sheet is 200' scale or smaller, use 36 size standard - same as R/W plans.

**HELPFUL HINTS**  
For P.O.T. & P.I. stations show & reference if it is not clear as to which & the stationing is associated with.

**REFERENCE FILE**  
--rw---\_pin.dgn  
Attachment: Coincident

**L LINE**  
LV=220  
CO=20  
LC=0  
WT=0

**Legend**

**RW\_V8. cel**  
AC=ROSLGD  
LV=217  
CO=17  
LC=0  
WT=2

**Bar Scale**

**RW\_V8. cel**  
AC=SCALE  
LV=225  
CO=25  
LC=0  
WT=3

**DATA FIELD**  
LV=225 FT=23  
CO=25 TX=60  
LC=0 ACTIVE  
WT=3 TXJ=CB

**HELPFUL HINTS**  
The radius point numbers for all curved existing R/W lines shall be shown on this sheet or in the existing R/W line table on Exhibit F5.

**HELPFUL HINTS**  
Add note that indicates how the stationing was derived.

**HELPFUL HINTS**  
The scale of the Survey sheets will generally be at a 1"=100' to a 1"=500' scale. Ultimately, the Scope of Work will define the scale of the ROS for each project.

## EXHIBIT-F3 ADOT CADD STANDARDS 2016

NO.	DATE	BY	DESCRIPTION OF REVISIONS

DRAWING NO.	D-7-T-940	DATE OF TRANSPORTATION	
SURVEY	MAY 2001	DESIGN AND OPERATIONS	
DRAWN/DATE	J. Crume/Sep 01	SECTION	
ADOT REVIEW	B. Gurney		
DATE OF FIELD SURVEY			
ROUTE NO.	S.R. 85	LOCATION	Lewis Prison - Gila River
SHEET	RS-2		

**HELPFUL HINTS**  
NOTE: All parameters shown on this sheet are relative to the plan scale of 1"=500'

**TEXT**  
LV=263 FT=1  
CO=63 TX=50  
LC=0 ACTIVE  
WT=2 TXJ=LB