



I-10/Koli Road Traffic Interchange Study

Welcome

**Interstate 10/Koli Road Traffic Interchange Study
Draft Environmental Assessment (EA) and
Design Memo (DM) Public Hearing**

Please sign in at the welcome table.
Please see a staff member if you need
Spanish or O'odham
interpretation assistance.

Consulte a un personal miembro si
necesita asistencia de interpretación
en español o en O'odham.



I-10/Koli Road Traffic Interchange Study

Public Hearing Format

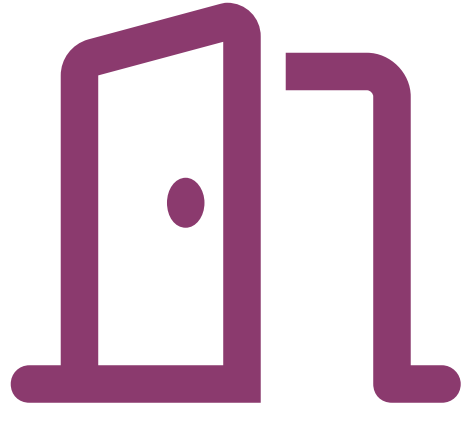

5:30 to 6:00 p.m.

Open House

- View display boards, exhibits, and videos at your own pace.
- Ask study team members questions.

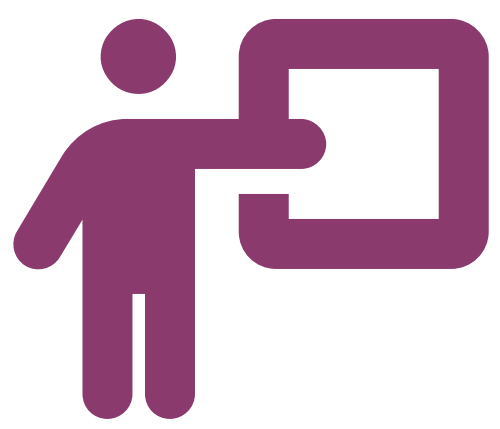

6:00 to 6:30 p.m.

Formal Public Hearing

- Formal presentation.



6:30 to 7:00 p.m.

Formal Comment Period and Open House

- Provide public verbal comments at the microphone.
- Provide private verbal comments to a court reporter.
- Provide written comments on the written or online comment forms.



I-10/Koli Road Traffic Interchange Study

Public Hearing Ground Rules

Formal Public Hearing/Comment Area

- Please remain quiet and leave the area for side conversations.
- Please do not interrupt speakers.

Open House Area

- Please refrain from interrupting conversations between study team members and meeting attendees.

Tonight's Agenda

1. Project overview and study area
2. Environmental process, NEPA requirements, purpose and need
3. Alternative selection process
4. Funding
5. Next steps and implementation
6. Formal public comment period



I-10/Koli Road Traffic Interchange Study

How to Provide Verbal Formal Comments



Speak at the microphone in the public forum following the presentation.



Speak privately to a court reporter at the comment station.

- Speak clearly so the court reporter can record your comment.
- State your first name and last name.
- State your comment.

All formal verbal comments will become part of the study record.



I-10/Koli Road Traffic Interchange Study

I-10 Wild Horse Pass Corridor

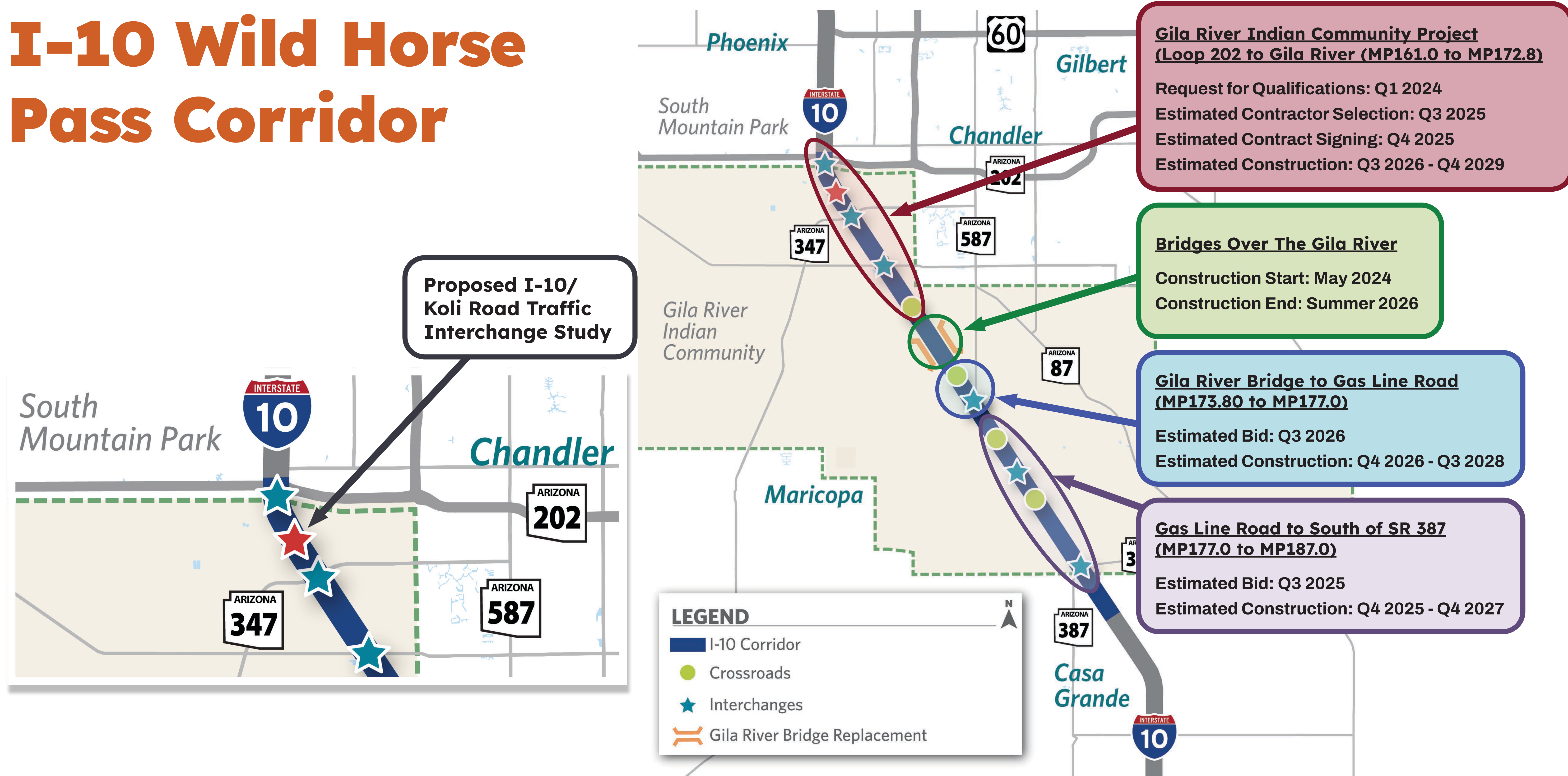



I-10/Koli Road Traffic Interchange Study

Study Area

Study Focus

Proposed new traffic interchange along I-10 between the existing Wild Horse Pass Boulevard and State Route 347/Queen Creek Road TIs.

Study Limits

Just north of the Wild Horse Pass Blvd Traffic Interchange, extends south of Queen Creek Road/SR 347, about half a mile east of I-10, and continues west to Maricopa Road.

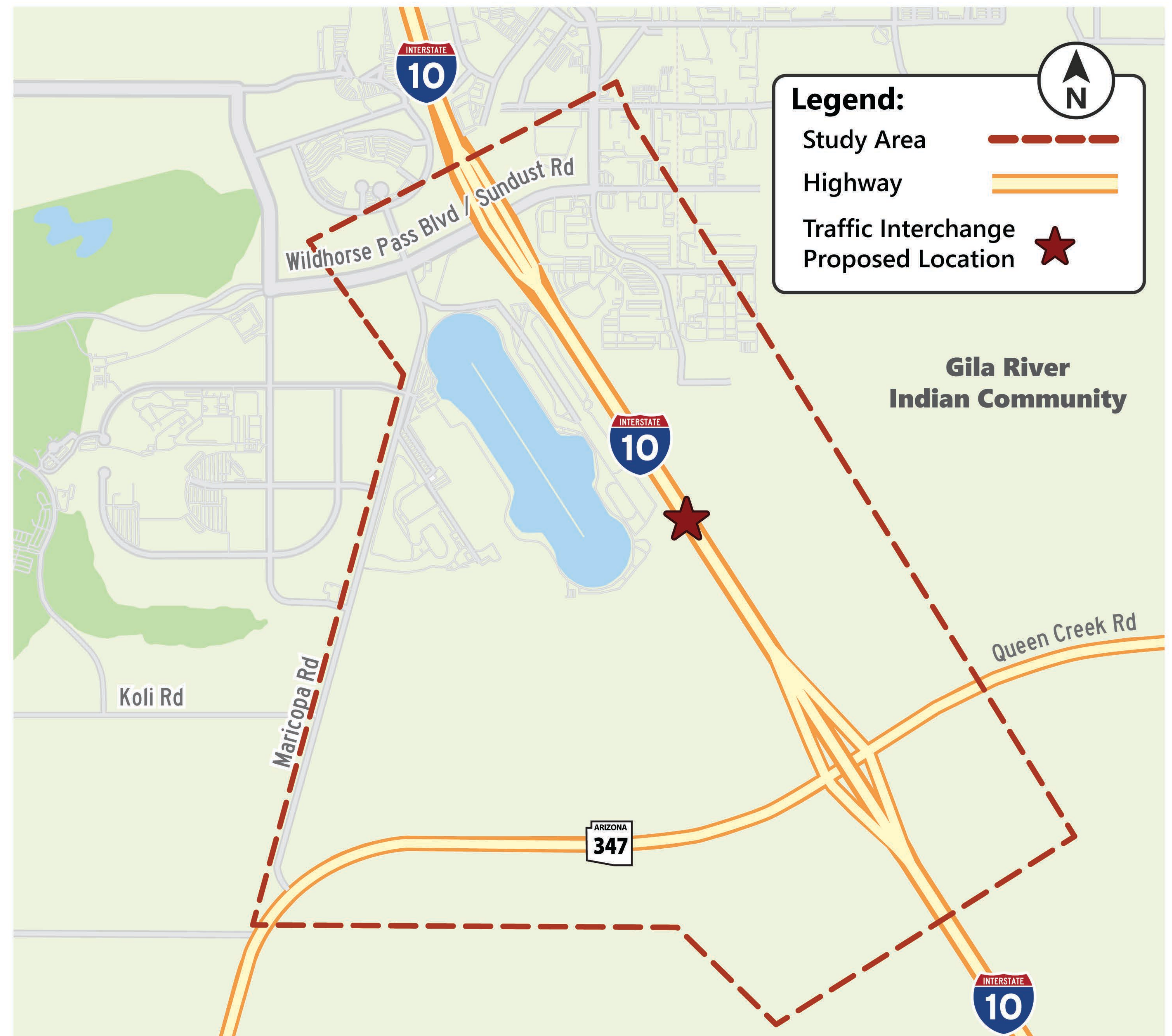



I-10/Koli Road Traffic Interchange Study

Purpose and Need

The purpose of the proposed I-10/Koli Road TI is to:



Provide efficient access to the Community to and from I-10.



Improve emergency vehicle response times from the Community Fire Station on Maricopa Road.



Improve traffic management on I-10 during incidents.



Accommodate growth in visitor population and employment.

The proposed I-10/Koli Road TI is needed to address:

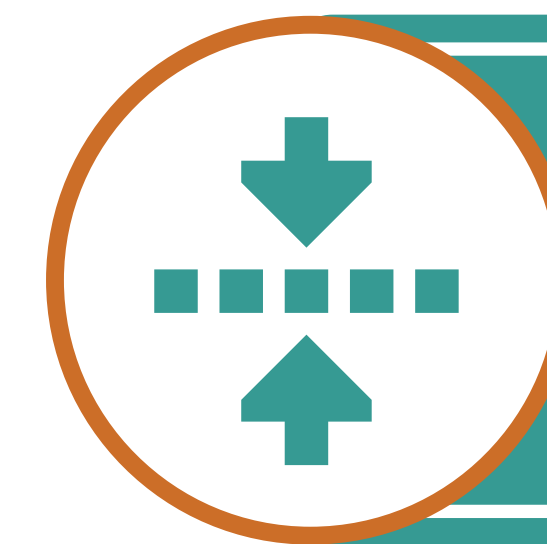

Less than efficient access to Community land.



Inadequate emergency vehicle response times during special events.



Substantial traffic management issues on I-10 during incidents.



Substantial visitor population and employment growth as the Wild Horse Pass area is developed.



I-10/Koli Road Traffic Interchange Study

NEPA Requirements

- The National Environmental Policy Act (NEPA) requires agencies to analyze and disclose adverse environmental impacts and potential mitigation.
- NEPA requires that applicable federal agencies review a project's impacts and potential mitigation measures documented during the NEPA process.
- An Environmental Assessment (EA) is the NEPA-level document being prepared to evaluate the potential impacts of the I-10/Koli Road Traffic Interchange project.
- The EA describes the need for the proposed action, alternatives developed for the proposed action, and the environmental impacts of the Recommended Build Alternative and the No-Build Alternative.

NEPA Disclosure

The environmental review, consultation, and other actions required by applicable Federal environmental laws for this project are being or have been carried out by ADOT pursuant to 23 U.S.C. 327 and a Memorandum of Understanding dated June 25, 2024, and executed by the Federal Highway Administration and ADOT.



I-10/Koli Road Traffic Interchange Study

Alternatives Evaluated

The study team evaluated alternatives that met the project's purpose while minimizing impacts. After screening, two build options, a Diamond Interchange and a Diverging Diamond Interchange, and a No-Build option were chosen for further study.

No-Build

- No improvements are made.
- Maintenance only.
- Baseline for comparison.

Diamond Interchange

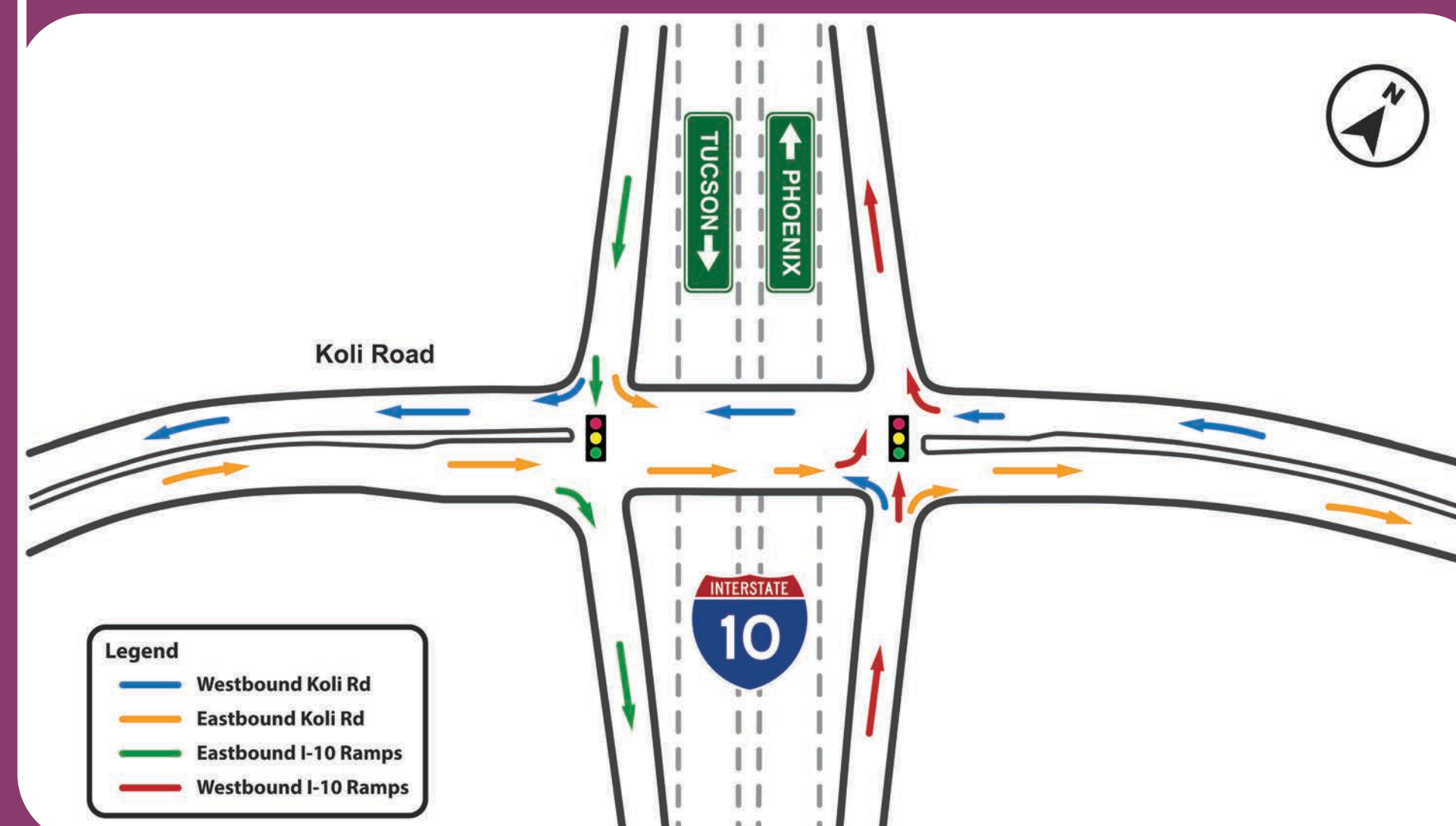

Diverging Diamond Interchange (DDI)

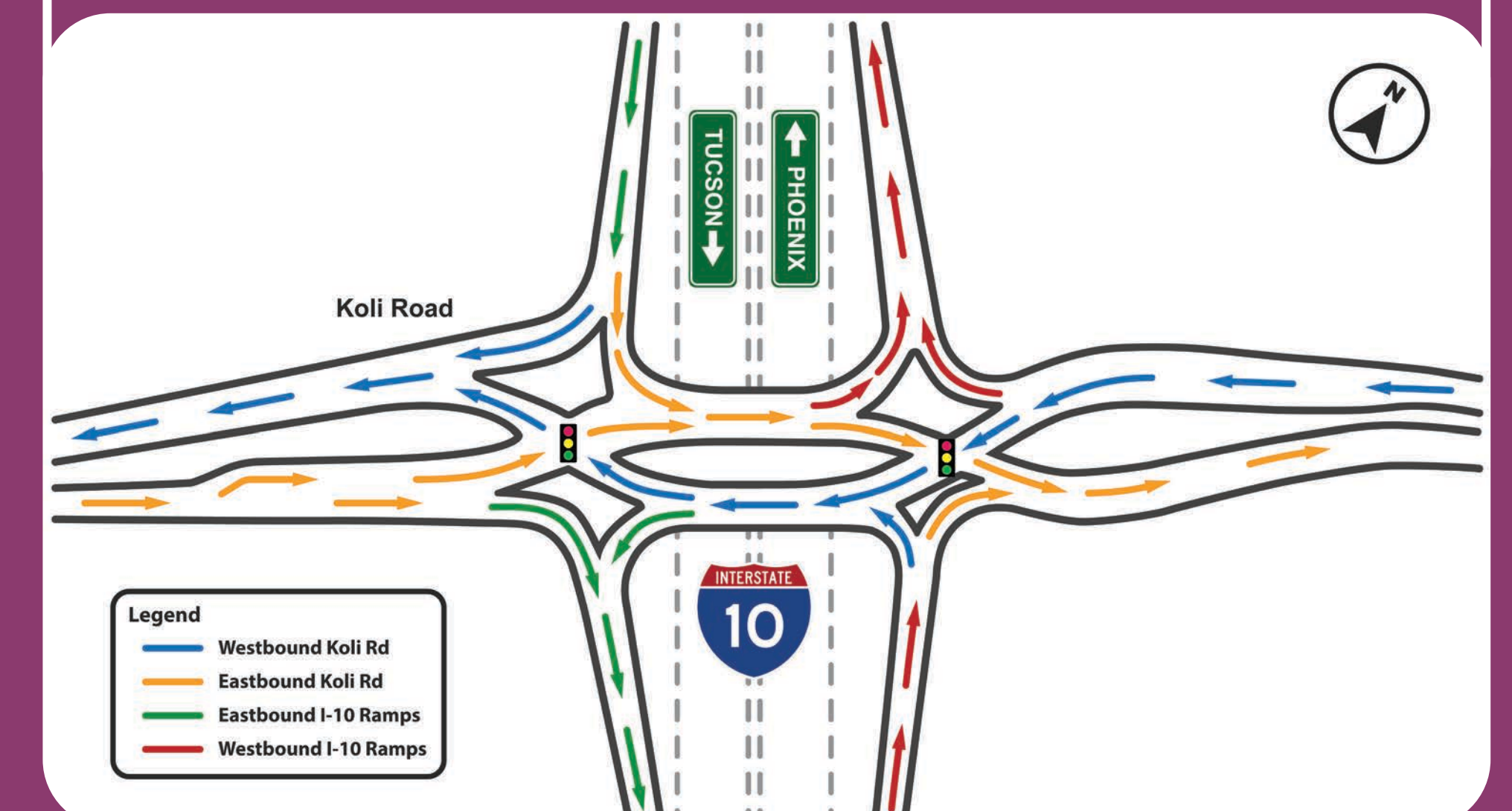



I-10/Koli Road Traffic Interchange Study

What is the No-Build Alternative?

- The No-Build Alternative represents the existing transportation system with ongoing maintenance.
- The No-Build Alternative provides a basis against which social, environmental and economic impacts can be measured.
- The No-Build Alternative is used as a baseline, or a benchmark, to compare against the build alternatives.



I-10/Koli Road Traffic Interchange Study

Recommended Build Alternative (RBA)

Diverging Diamond Interchange (DDI)

ADOT, with input from the Gila River Indian Community, Bureau of Indian Affairs, Federal Highway Administration, Maricopa Association of Governments, stakeholders and the public, has selected the Diverging Diamond Interchange as Recommended Build Alternative (RBA) for the Koli Road TI. Refer to the published Environmental Assessment for in-depth detail about the RBA.

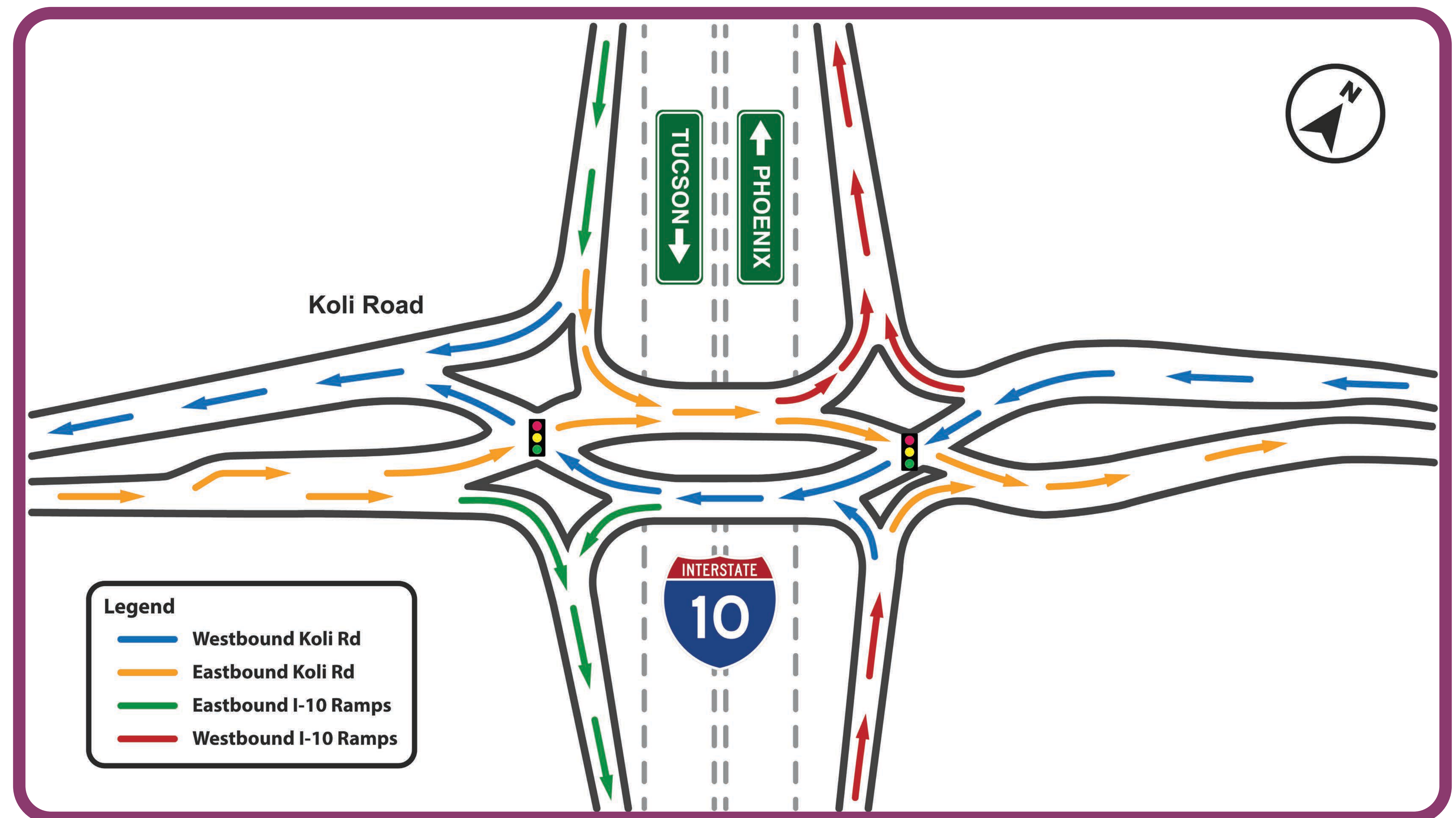



I-10/Koli Road Traffic Interchange Study

How a DDI works:

Scan the QR code to watch a video on how the DDI works

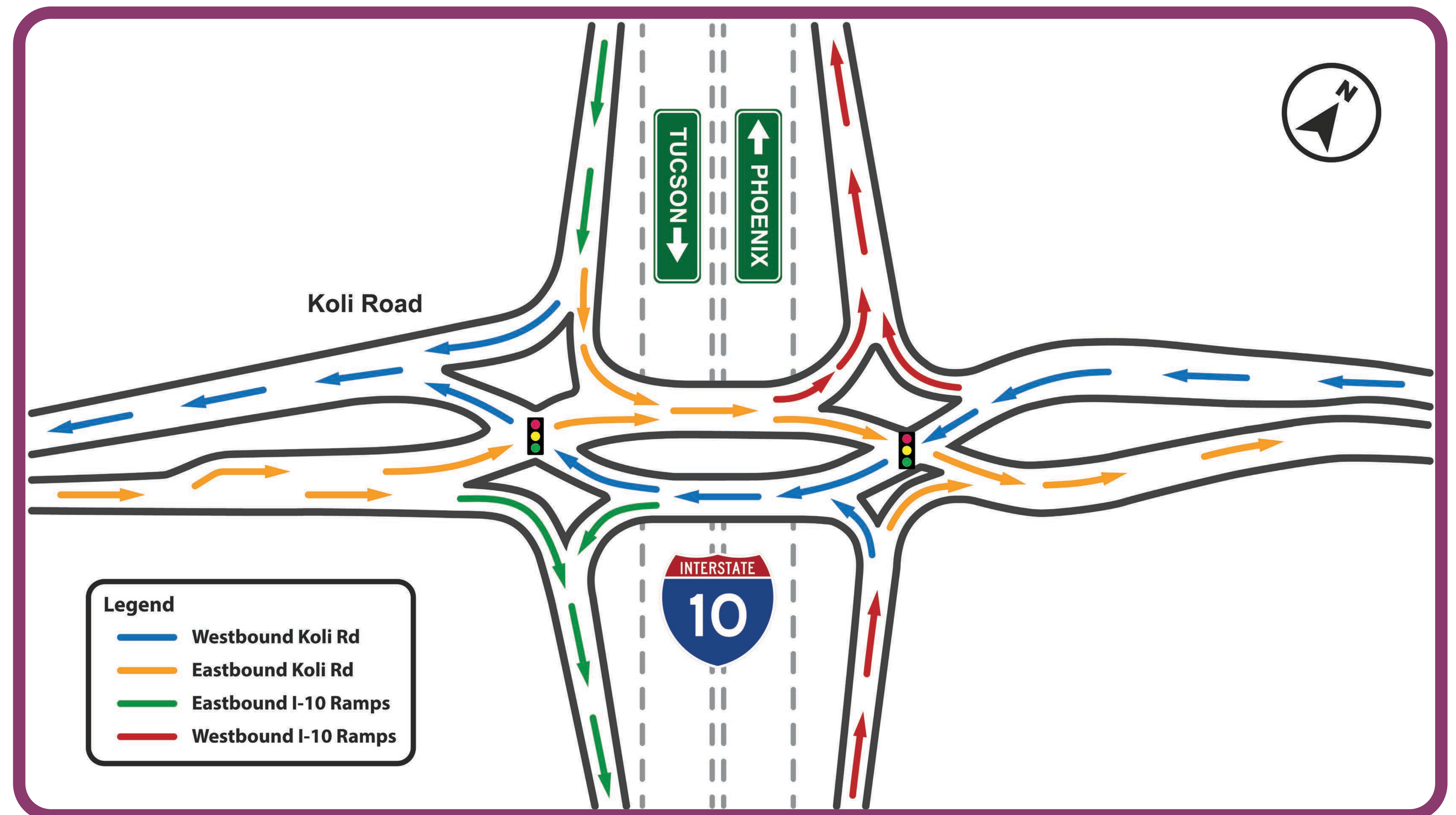



I-10/Koli Road Traffic Interchange Study

Recommended Build Alternative (RBA)

Local Road Typical Section

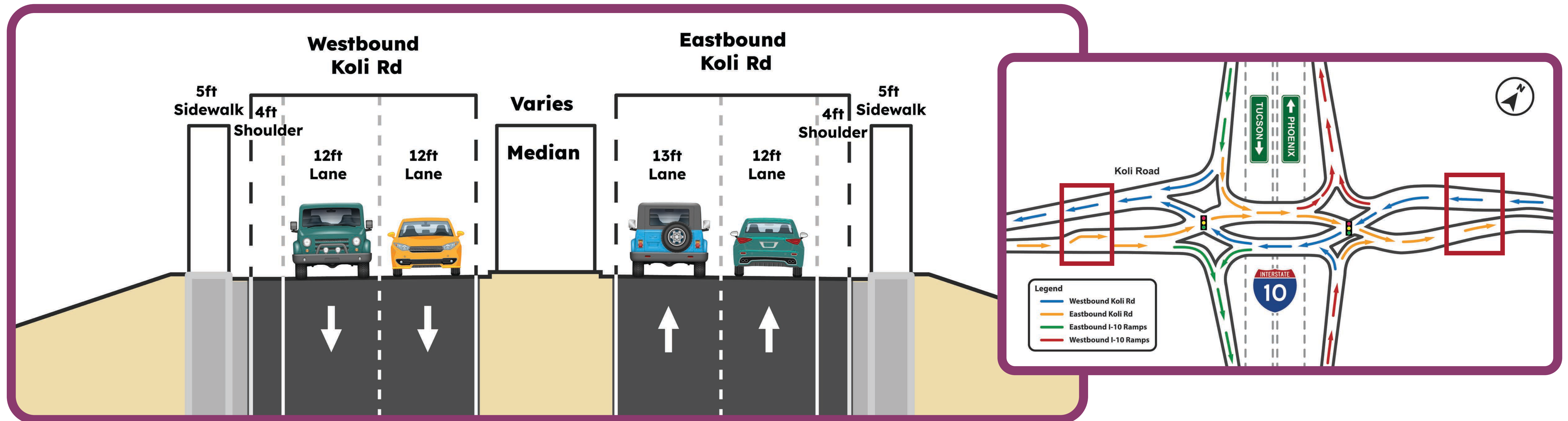

The Community will construct the local road extensions, connecting the traffic interchange to Maricopa and Kyrene roads in the future.



I-10/Koli Road Traffic Interchange Study

Recommended Build Alternative (RBA)

Typical Section Along Proposed Bridge

- The eastbound bridge includes barriers, shoulders, two left-turn lanes to westbound I-10 toward Phoenix, two thru lanes, and a sidewalk.
- The westbound bridge includes barriers, shoulders, one left-turn lane to eastbound I-10 toward Tucson, and two thru lanes.

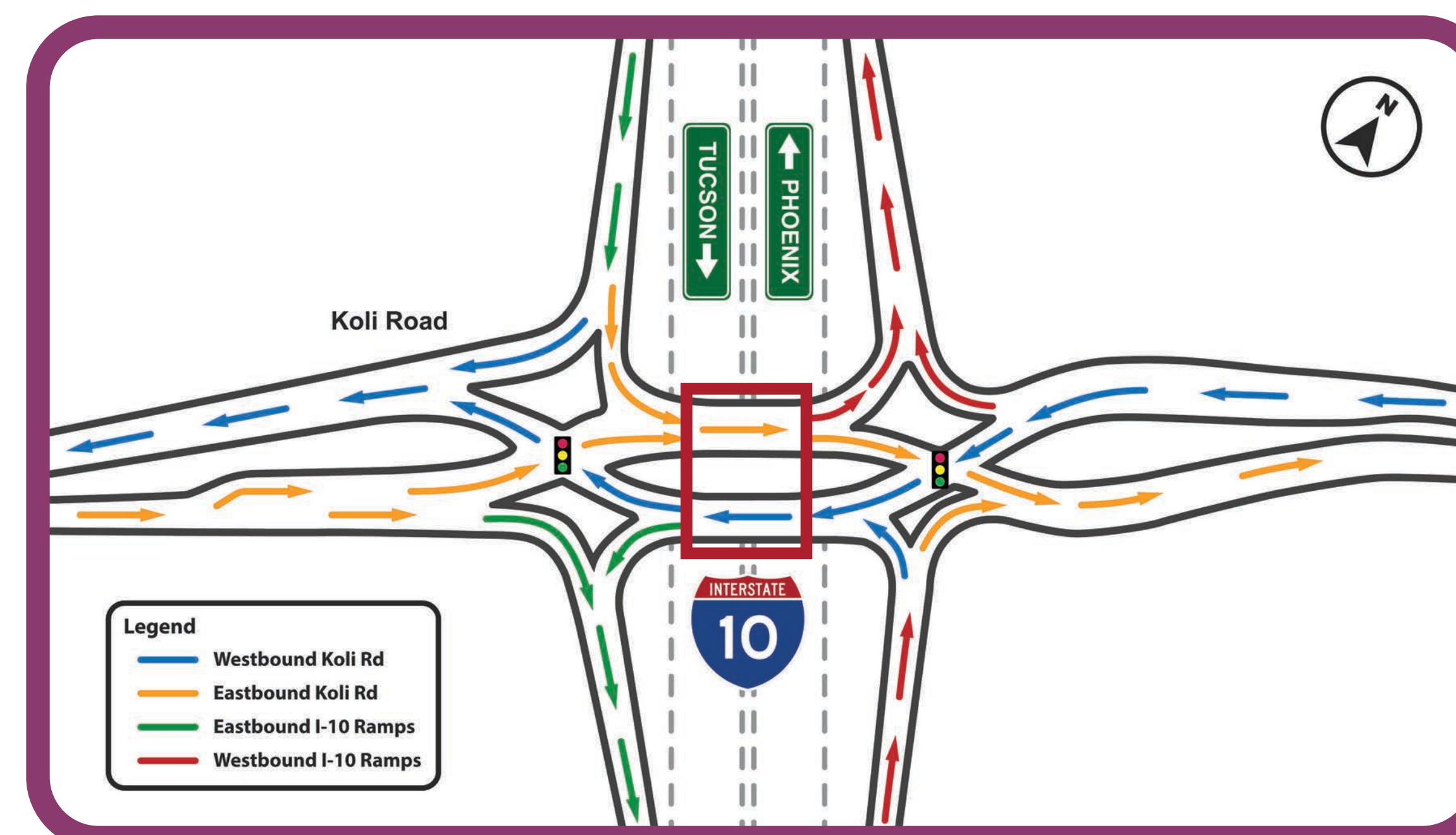
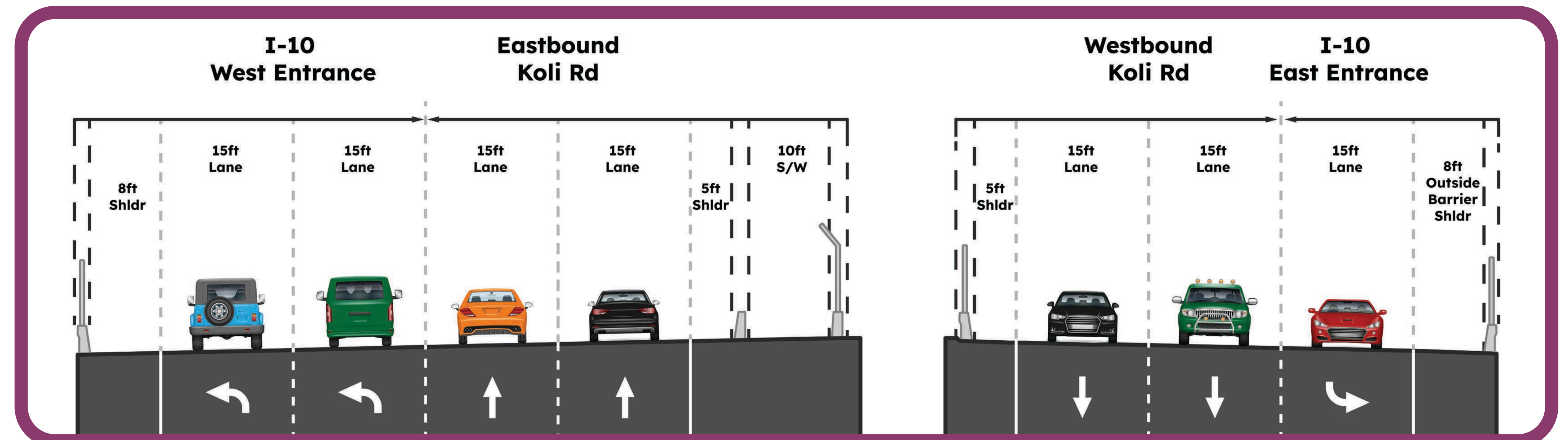



I-10/Koli Road Traffic Interchange Study

Anticipated Funding

If a Build Alternative is selected, the **Maricopa Association of Governments** will fund Right of Way, Utility Relocation and Construction of the Koli Road Traffic Interchange in the anticipated years of expenditure, FY25-26. The program budget is shown below.

- » Pre-Design was funded in FY2024-2025
- » Right of Way & Utility and Construction are budgeted for FY2025-2026

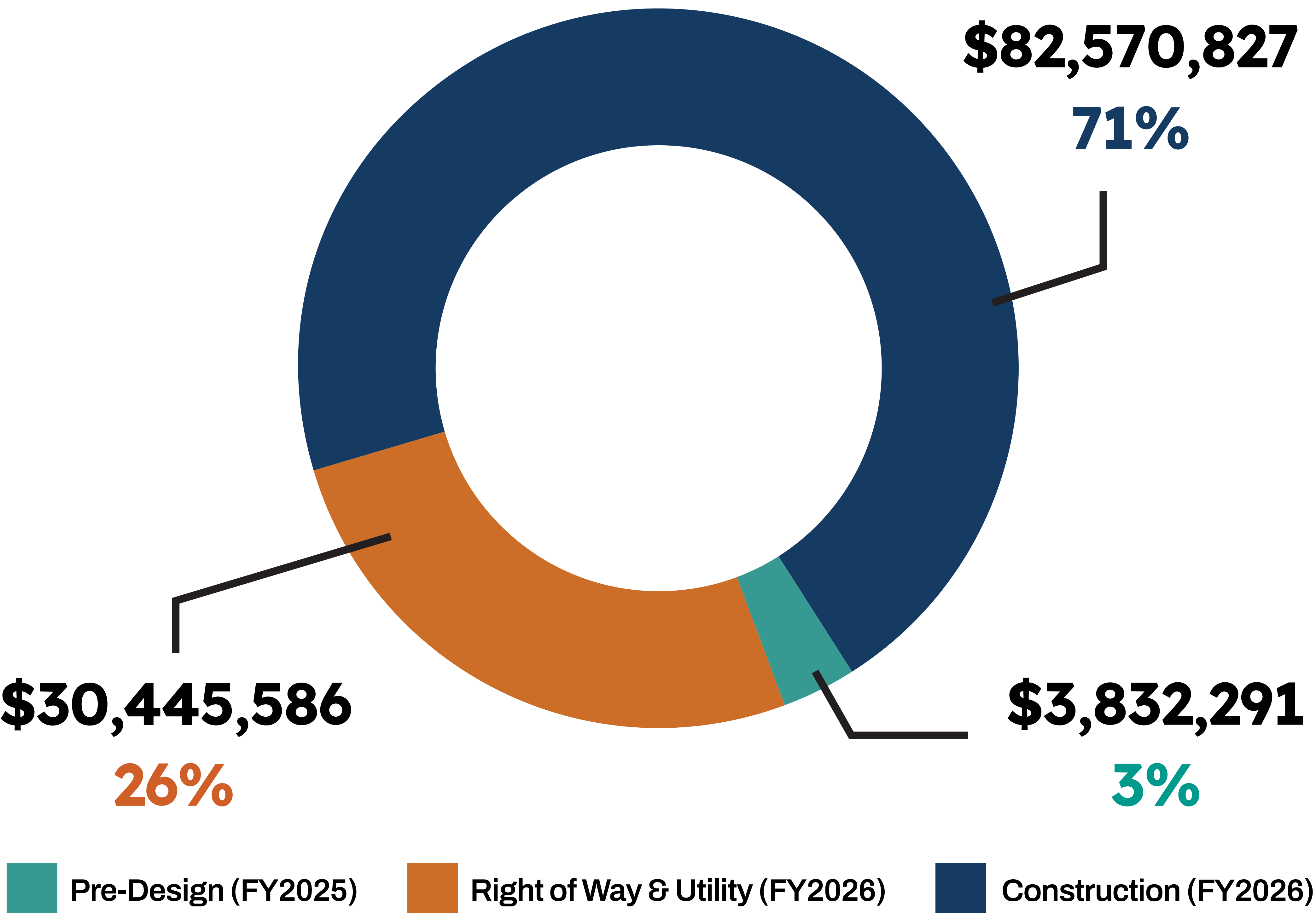



I-10/Koli Road Traffic Interchange Study

Next Steps

Following the close of our comment period on Aug. 13, 2025, the study team will review, evaluate, and respond to all comments from the partner agencies and the public.

ADOT, in cooperation with the Gila River Indian Community, Maricopa Association of Governments, and the Federal Highway Administration, will then select a final alternative.

This selection, combined with the input during the public comment period, will be documented in the final EA, NEPA decision, and DM documents.

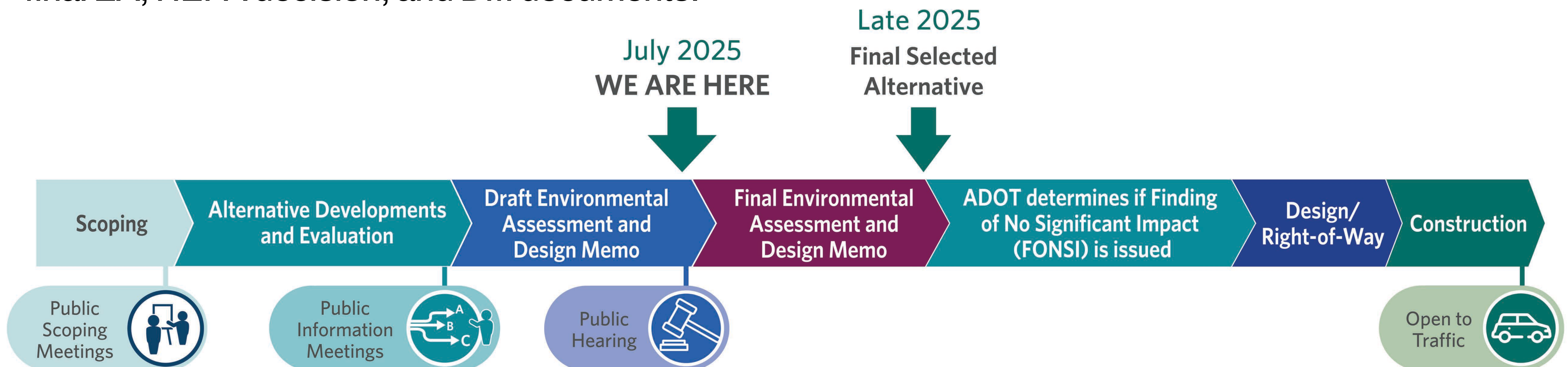



I-10/Koli Road Traffic Interchange Study

How to submit comments at the public meeting:

- Formal public verbal comments documented by a court reporter.
- Formal private verbal comments directly to a court reporter.
- Written comments submitted on the comment form.

How to submit comments after the public hearing:



Email:
koliroad@azdot.gov



Visit the website and leave a comment: azdot.gov/koliroad



Call bilingual project information line:
855.712.8530



USPS Mail:
I-10/Koli Road Traffic Interchange
Study Office
7130 W. Fairview St.
Chandler, AZ 85226

Formal Public Comment Period ends Aug. 13, 2025



I-10/Koli Road Traffic Interchange Study

Aesthetics of the Bridge

Bridge Fences

Basket Pattern

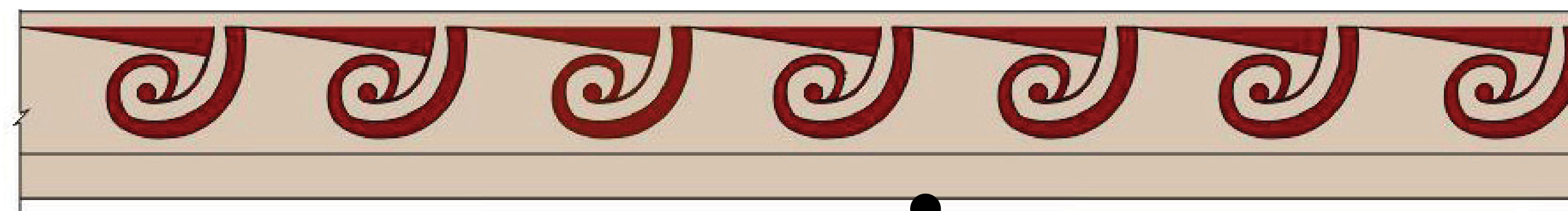
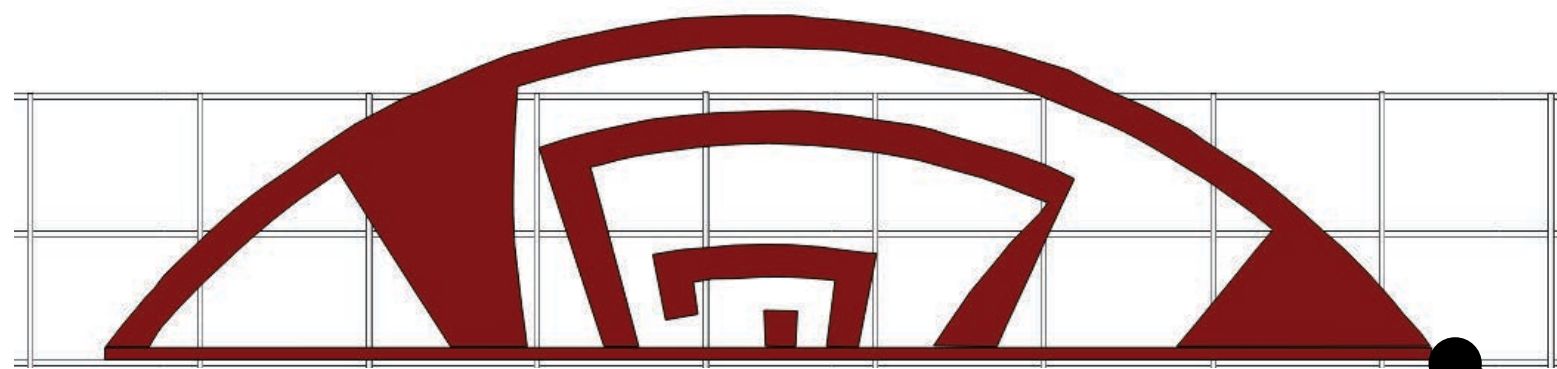

Bridge Barriers

Flowing River Pattern

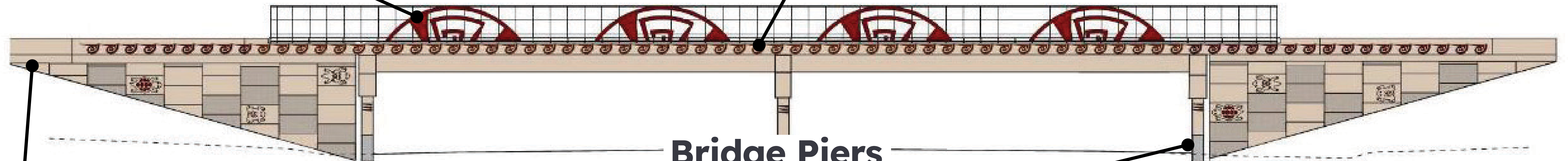

Retaining Wall

River Rock, Sand and Animal Patterns

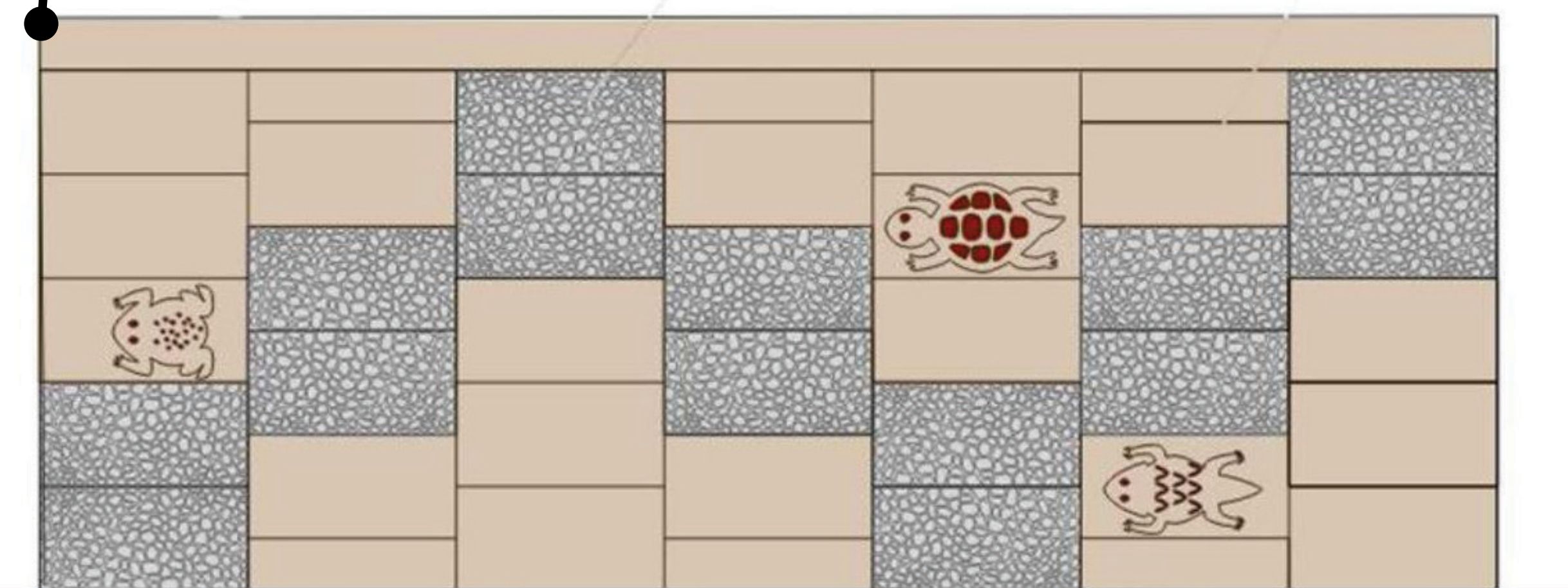

Bridge Piers

Flag Pattern

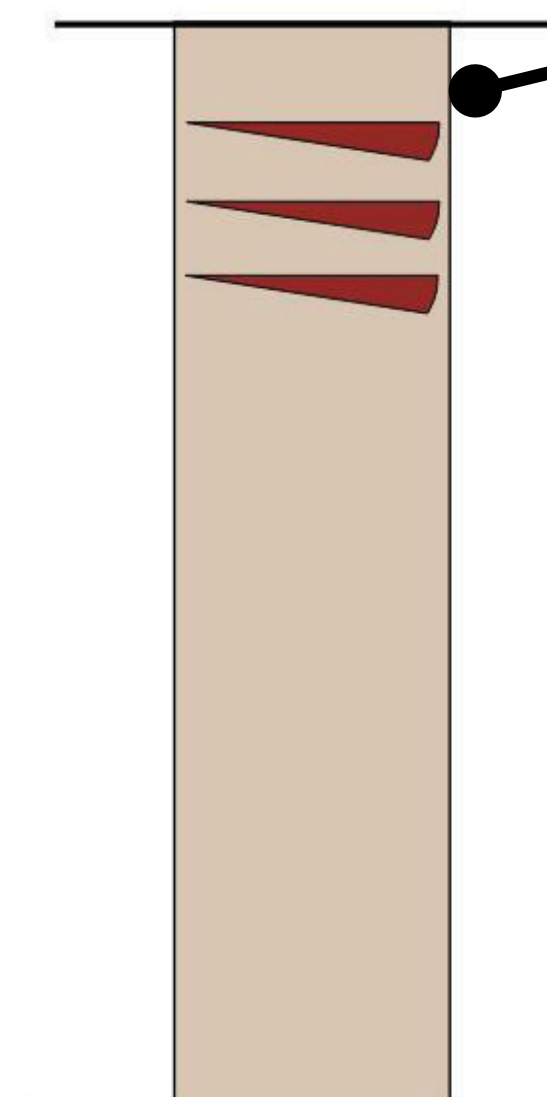

ADOT worked with Gila River Indian Community artists to develop a plan for aesthetics in the overall corridor. The bridges will be painted in ADOT Standard Tan. The accent and details will be painted in Hohokam Pottery Red.



I-10/Koli Road Traffic Interchange Study

Wild Horse Pass: Koli Road Traffic Interchange Location Study

- This independent study evaluated the alternative alignments to connect with the proposed I-10/Koli Road Traffic Interchange.
- The W-02 alternative west of I-10 is recommended for future consideration because it meets the study's criteria and follows the existing grid patterns throughout the surrounding area. W-02 accommodates future development and facilitates driver awareness of naming conventions.

Date: February 1, 2024 **Prepared for:** Gila River Development Authority

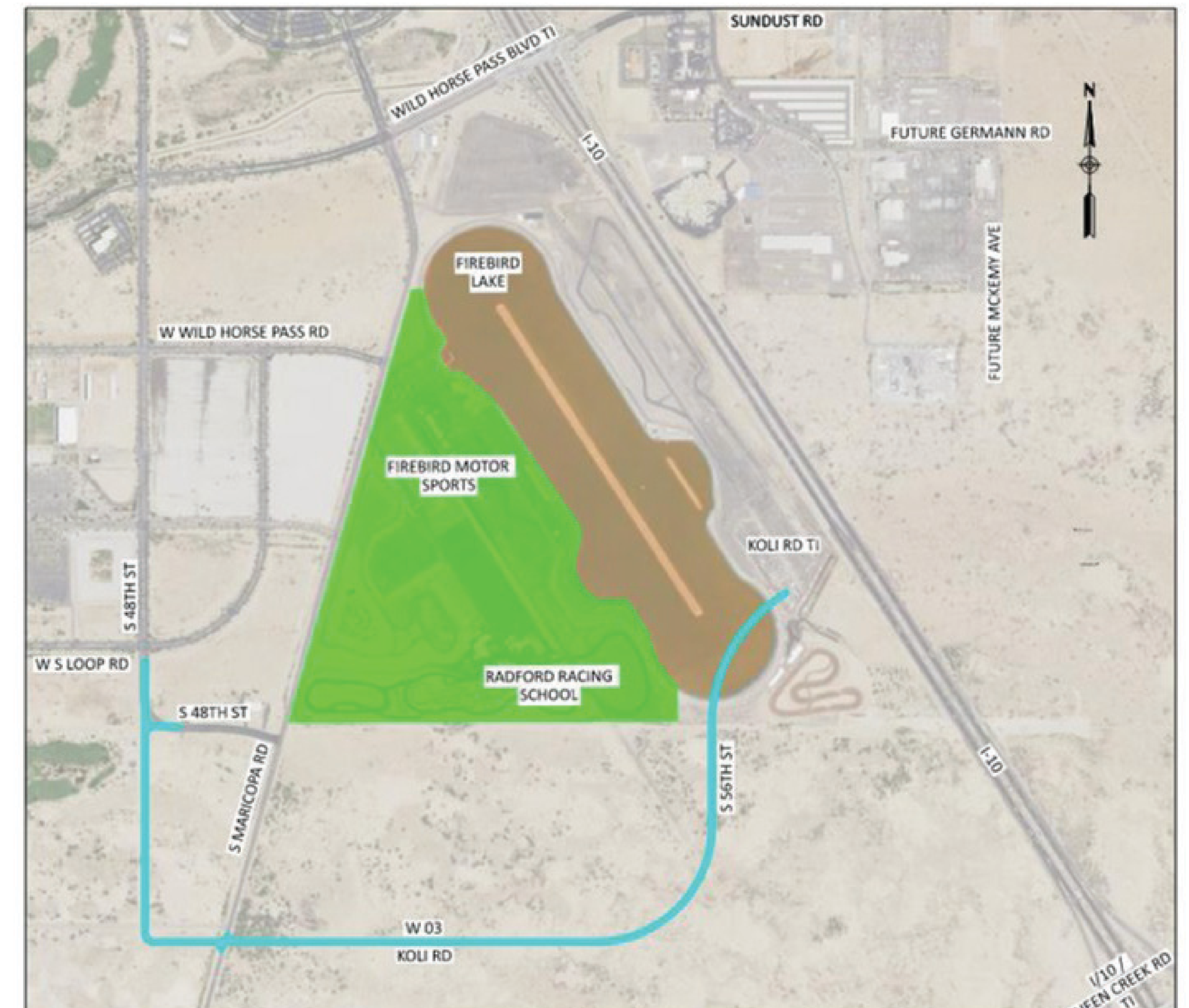
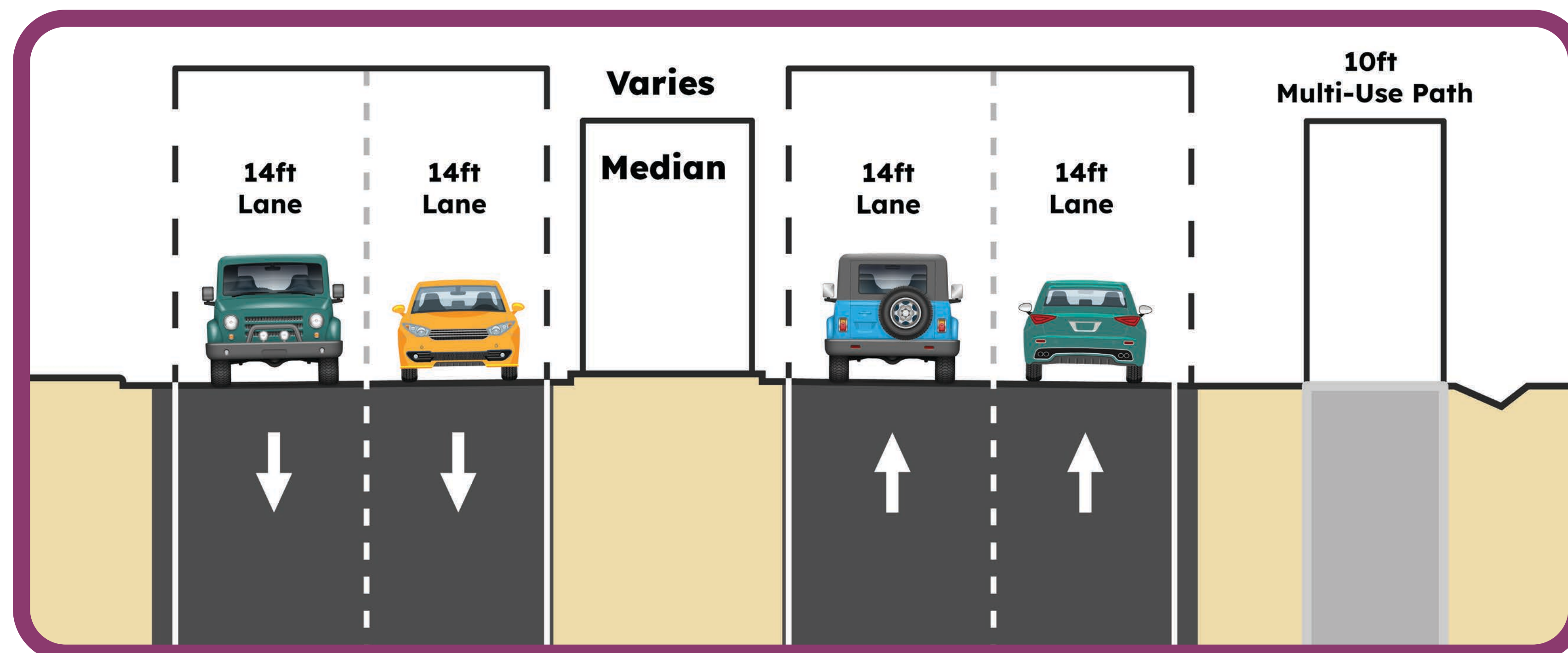



I-10/Koli Road Traffic Interchange Study

Environmental Findings

No Significant Environmental Impacts (Identified to Date)

Cultural Resources:

- No cultural resources located in the project footprint/area of disturbance.

Biological Resources:

- Permanent disturbance of 15 acres of Sonoran Desert scrub habitat would affect foraging, breeding, or dispersal habitat for some species.
- Species, including monarch butterflies, western burrowing owls, migratory birds, and some Community Focal Species, if present, could be affected during construction; most would avoid the area in favor of nearby similar habitat.
- Mitigation is in place to prevent or reduce potential harm to monarch butterflies, burrowing owls, and migratory birds.
- Species impacts are anticipated to be minor because the habitat is low in plant variety and density, so wildlife use is limited.





I-10/Koli Road Traffic Interchange Study

Environmental Findings

No Significant Environmental Impacts (Identified to Date)

Water Resources:

- No washes considered waters of the U.S.
- Stormwater runoff could affect waters downstream of the project, but measures are in place to protect water quality.
- No impacts to irrigation ditches, the Gila Drain or Community-owned wells.

Air Quality:

- Study indicates no adverse effects to air quality from the project.
- Anticipate FHWA providing air quality conformity sometime after the public hearing.
- No adverse impacts related to other environmental resource areas and categories analyzed, e.g., noise, hazardous materials, traffic, visual resources.

