



I-10 Broadway Curve Improvement Project Virtual Public Meeting

Wednesday, Aug. 4, 2021



Arizona Department
of Transportation

Thank you for your patience. The Virtual Public Information Meeting presentation will begin at 6 p.m.

If you are having technical difficulties, contact WebEx Help at 1.866.229.3239.

If you are having Tele-Town Hall difficulties, contact 630.605.8236.

Si necesita traducción al español, por favor marque al número de teléfono 1.855.756.7520, extensión 73681#





Welcome!

- All participants have been muted to avoid background noise.
- If you are having technical difficulties, call WebEx Help at **1.866.229.3239**.
- Following the meeting presentation, we will take comments and questions online and by phone. Instructions will be provided.
- This meeting is being recorded, and all comments and questions will be part of public record.



ADOT



**MARICOPA
ASSOCIATION of
GOVERNMENTS**

 **FHWA**



City of Phoenix



ADOT

Arizona Department
of Transportation



Closed Captioning

- For attendees who would like to view closed captioning, in the chat there will be a link to access the captions.
- The closed captioning will be in English and Spanish.





Agenda

- Meet the Team
- Project Overview/Scope of Work
- Progress
- Construction Schedule
- How to Stay Informed
- Q&A



Broadway Curve Constructors

PULICE

TY·LIN
INTERNATIONAL



AZTEC 

FLATIRON

Stanley Consultants INC.



ADOT

Arizona Department
of Transportation



Project Overview

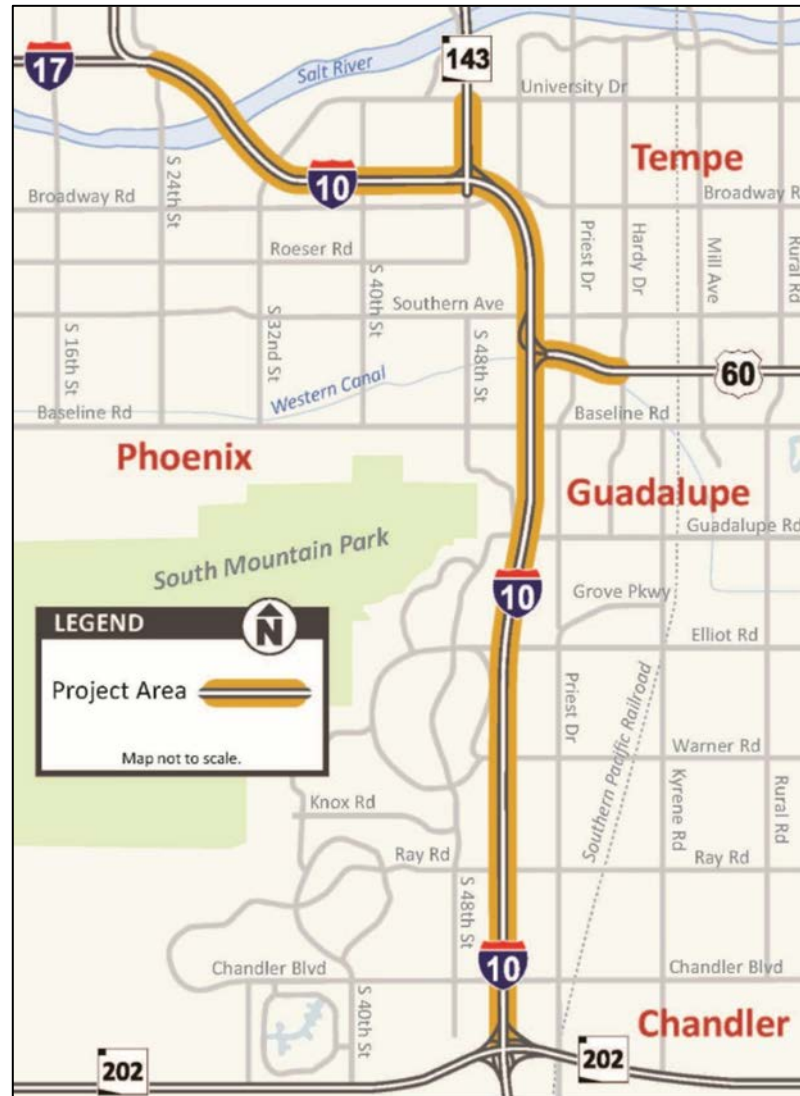



I-10 Improvements

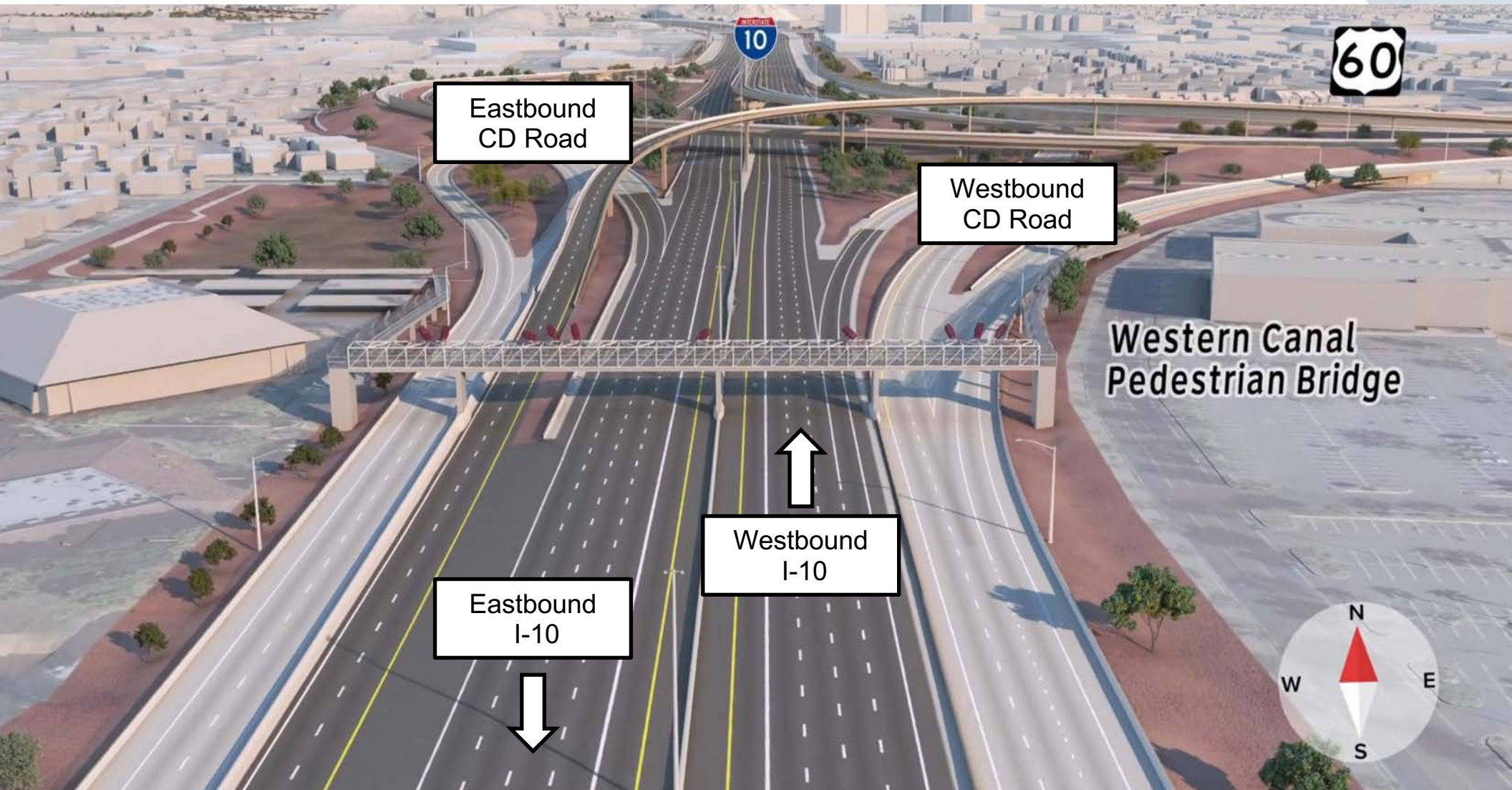

Arizona Department
of Transportation



I-10 and Ray Road Today

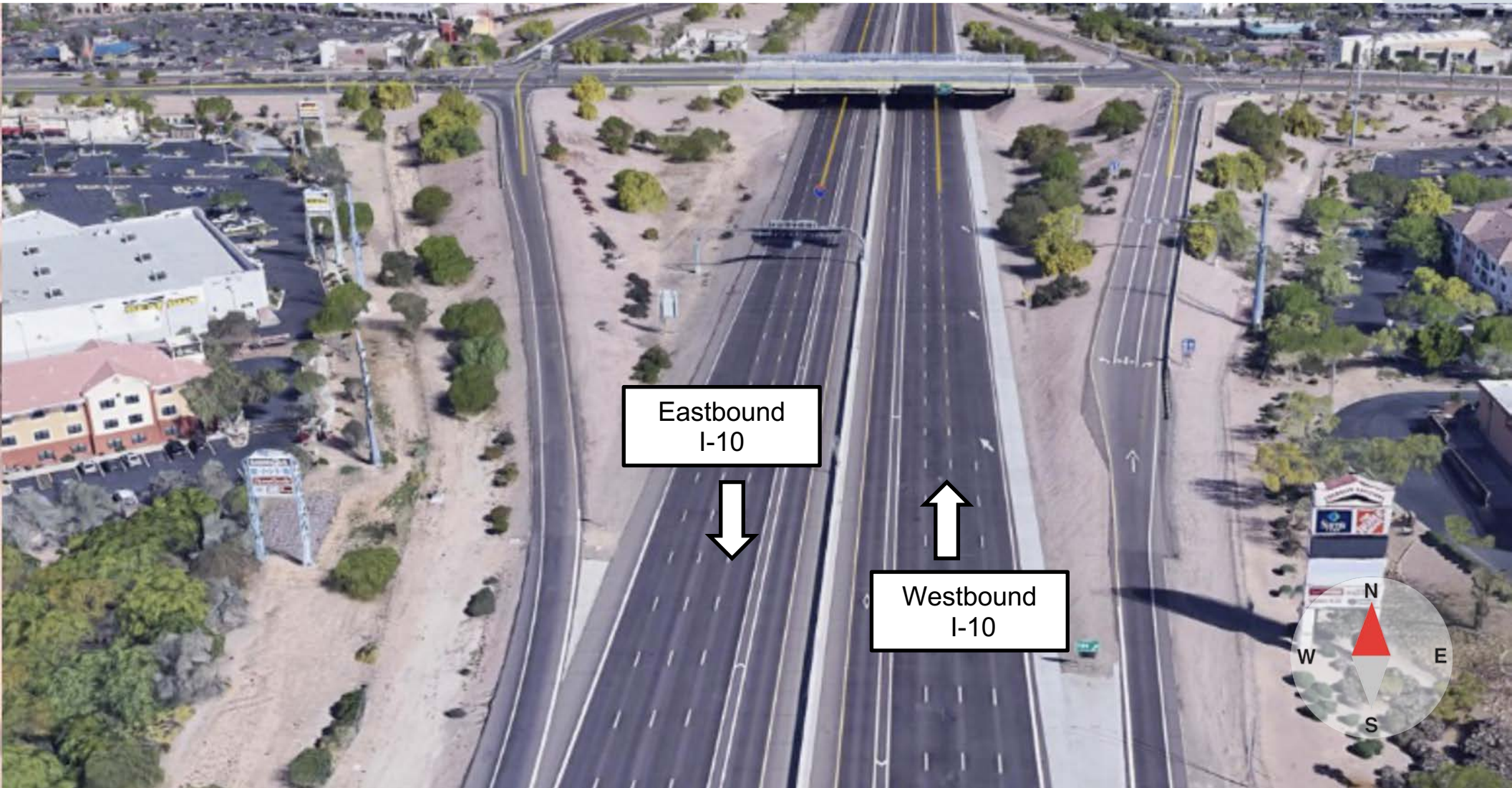



Future I-10 and Ray Road

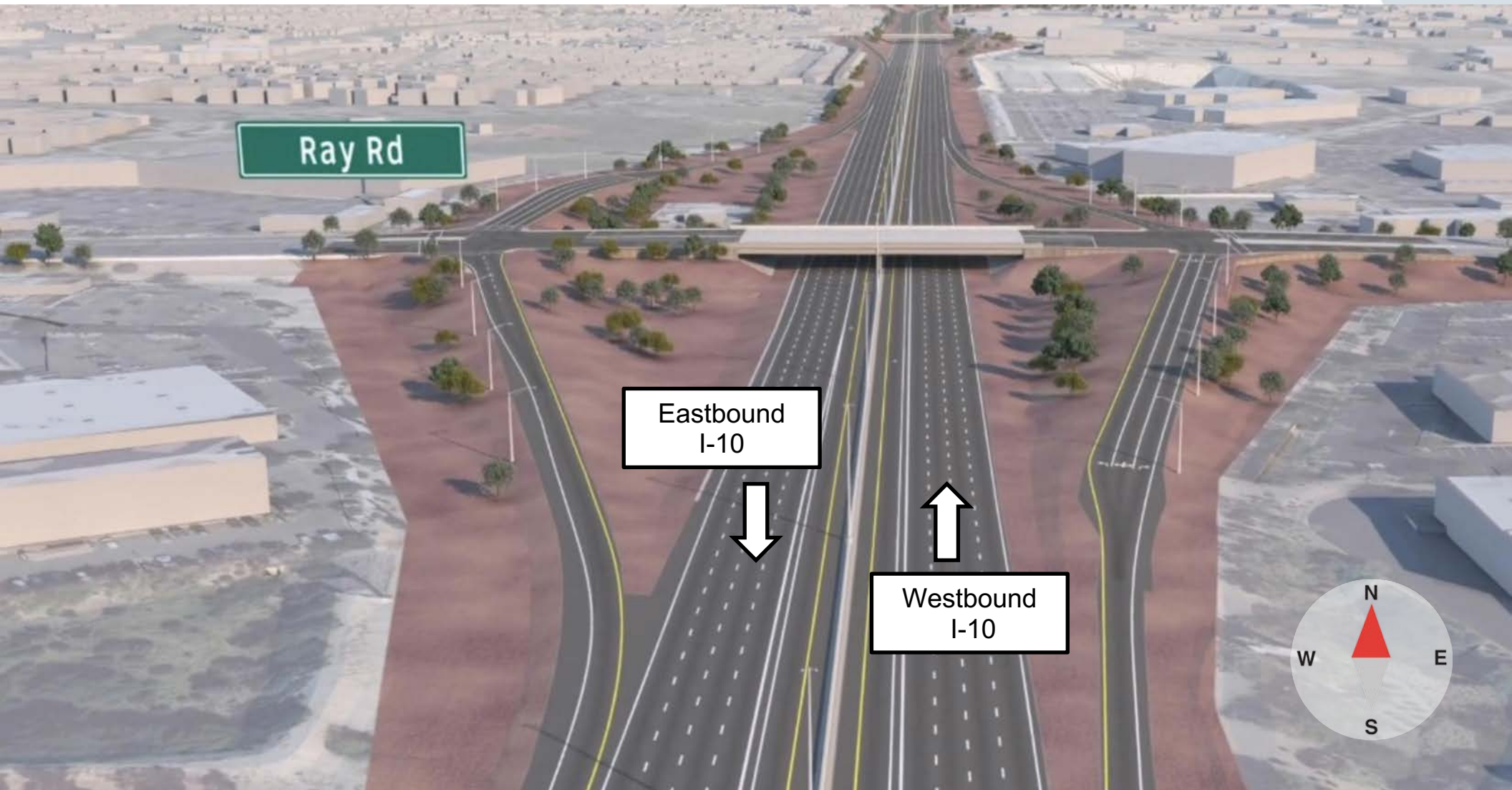

Arizona Department
of Transportation



I-10 at US 60 Today

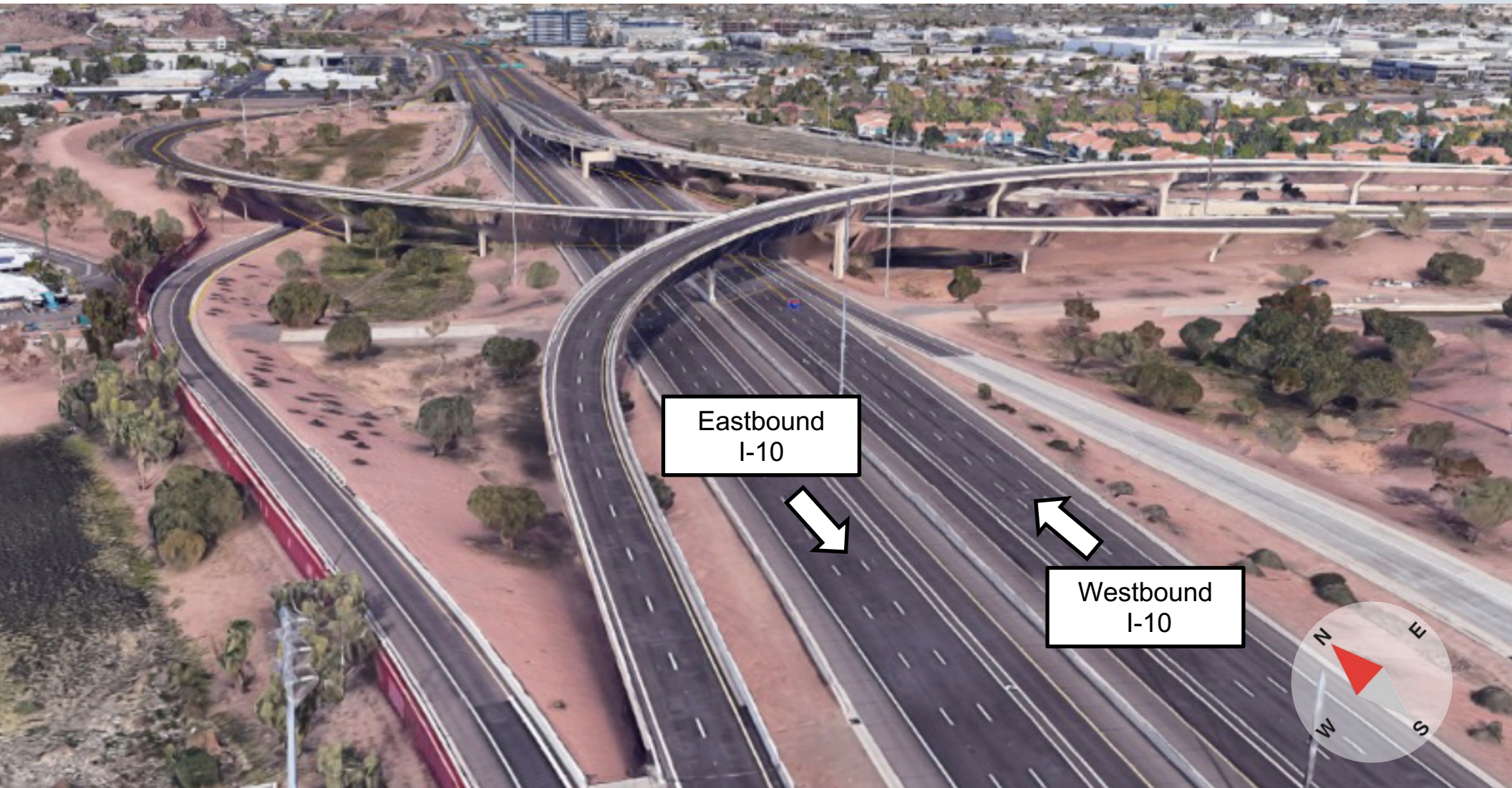

Eastbound
I-10

Westbound
I-10



Arizona Department
of Transportation



Future I-10 at US 60

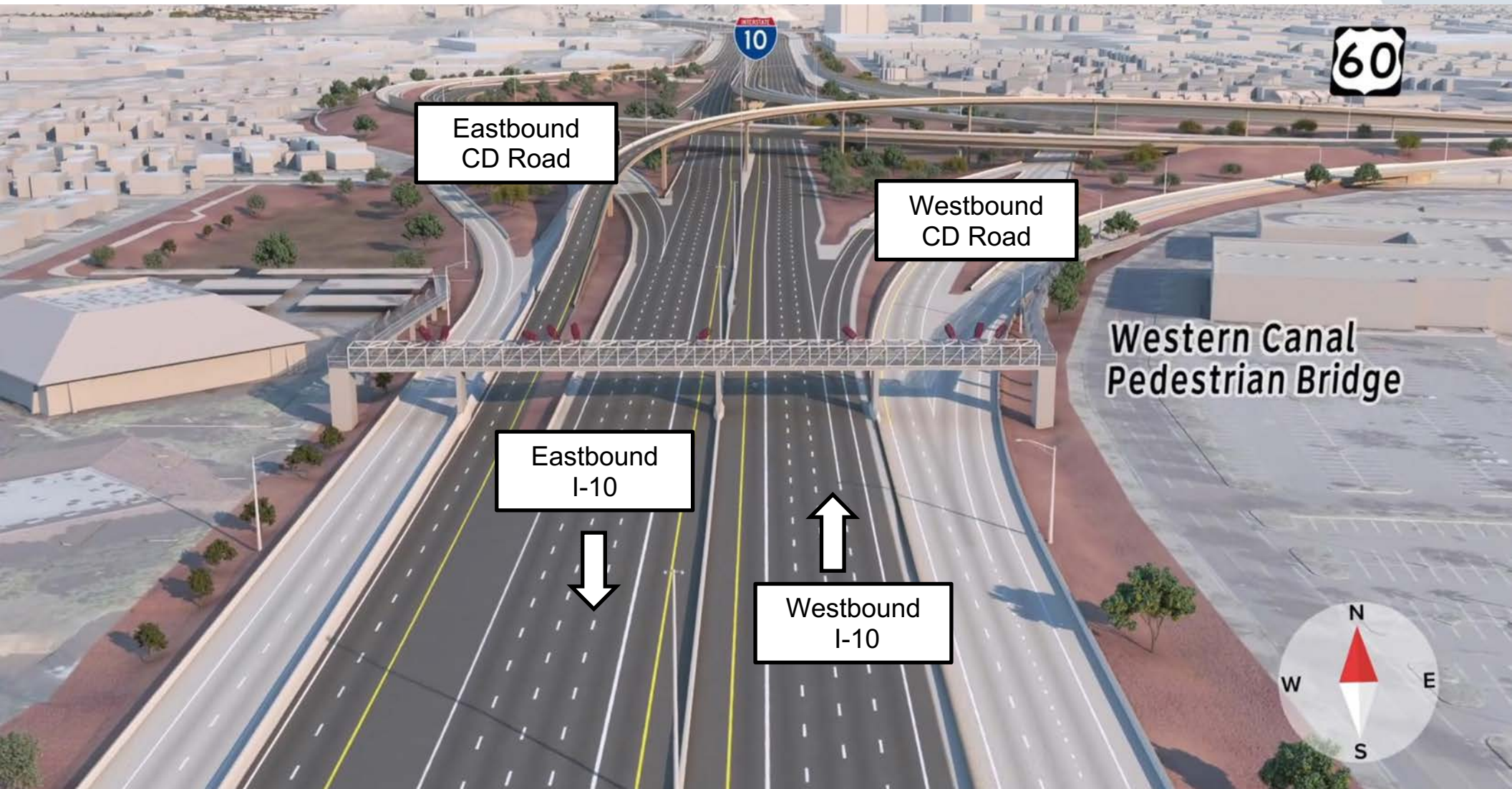

Arizona Department
of Transportation



US 60 and I-10 Today





Future US 60 and I-10

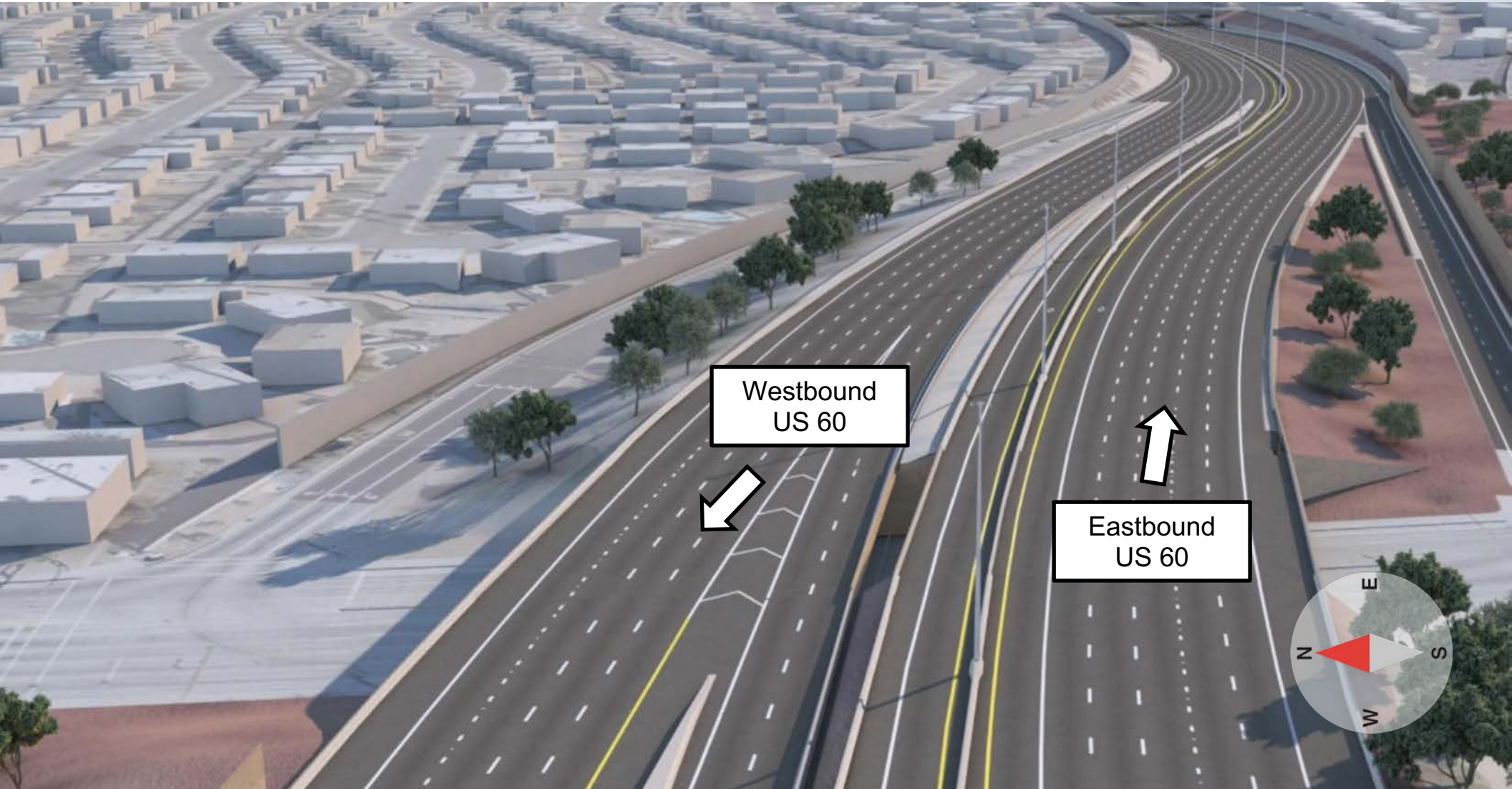

Collector-Distributor Roads

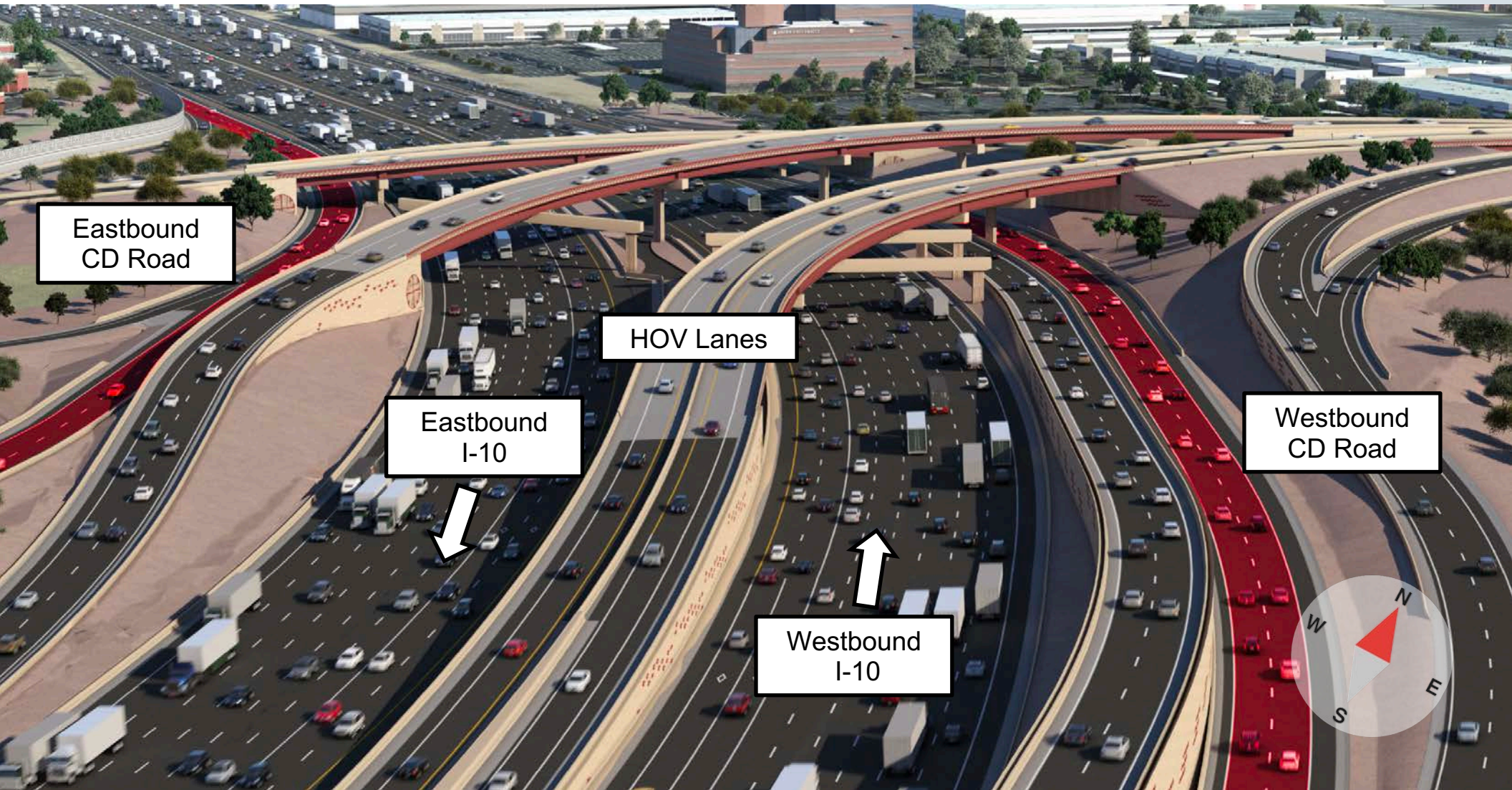



Collector-Distributor Roads

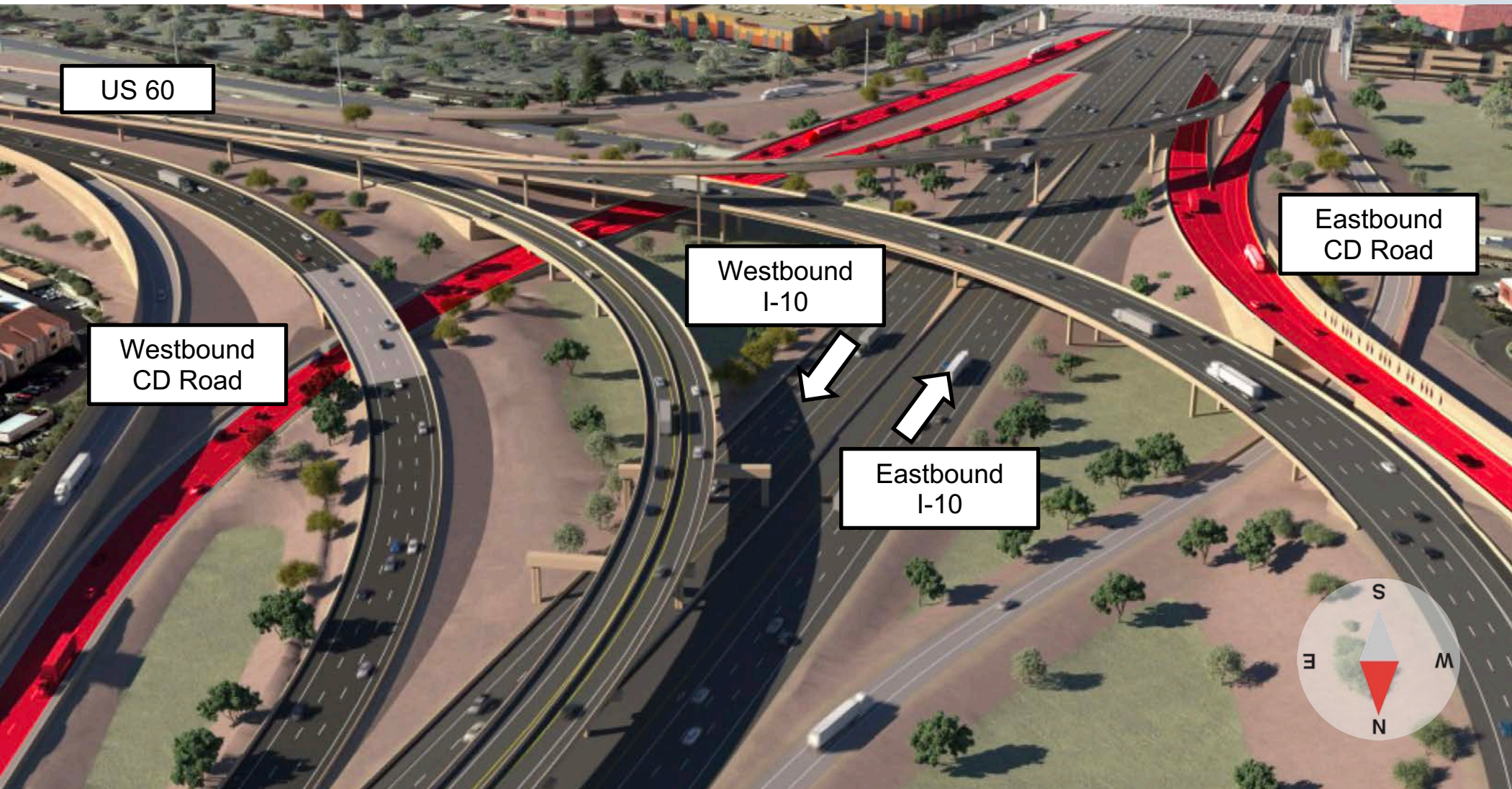



Broadway Curve Today





Future Broadway Curve





Broadway Road Bridge Today

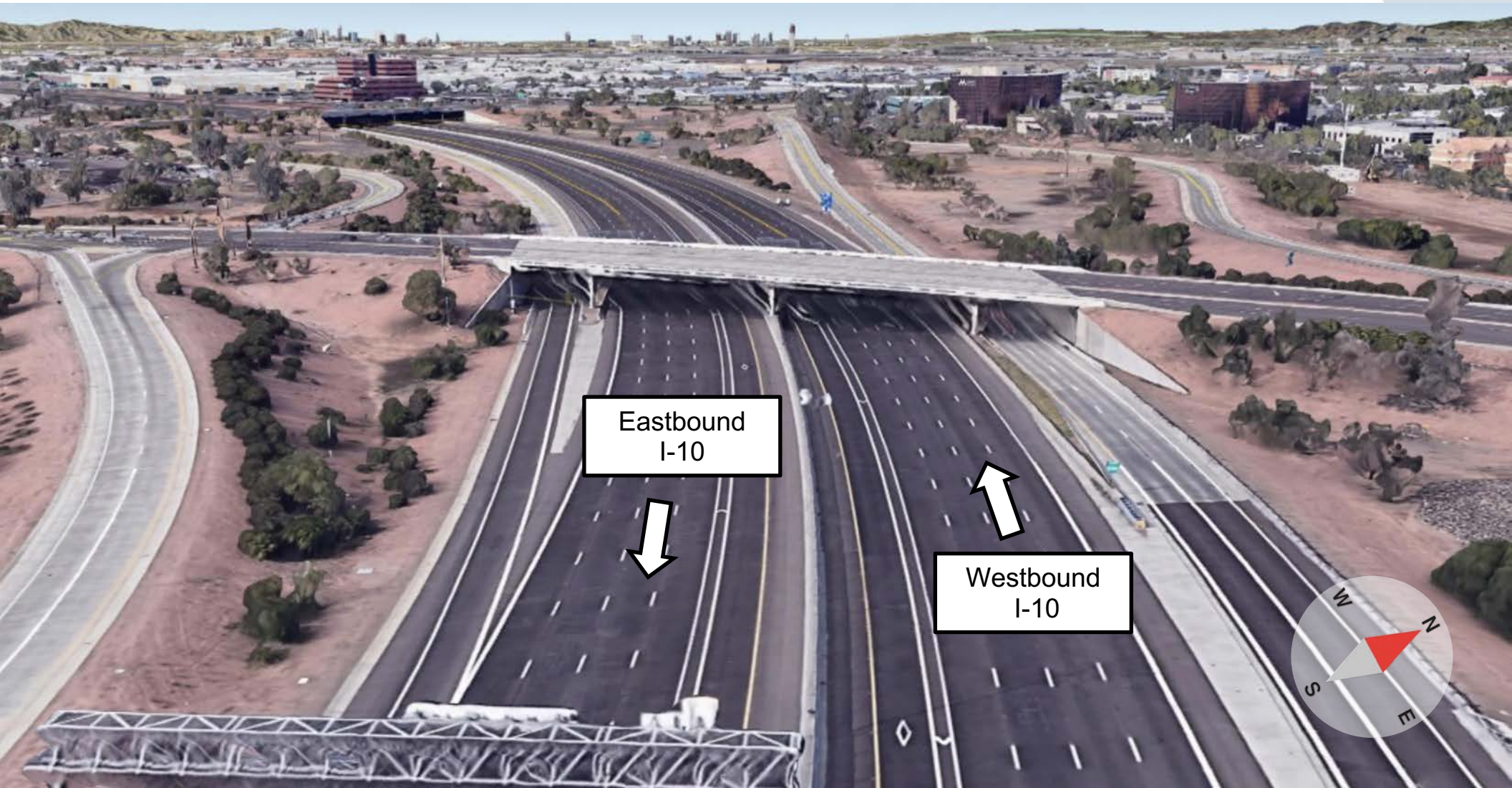



Future Broadway Road Bridge

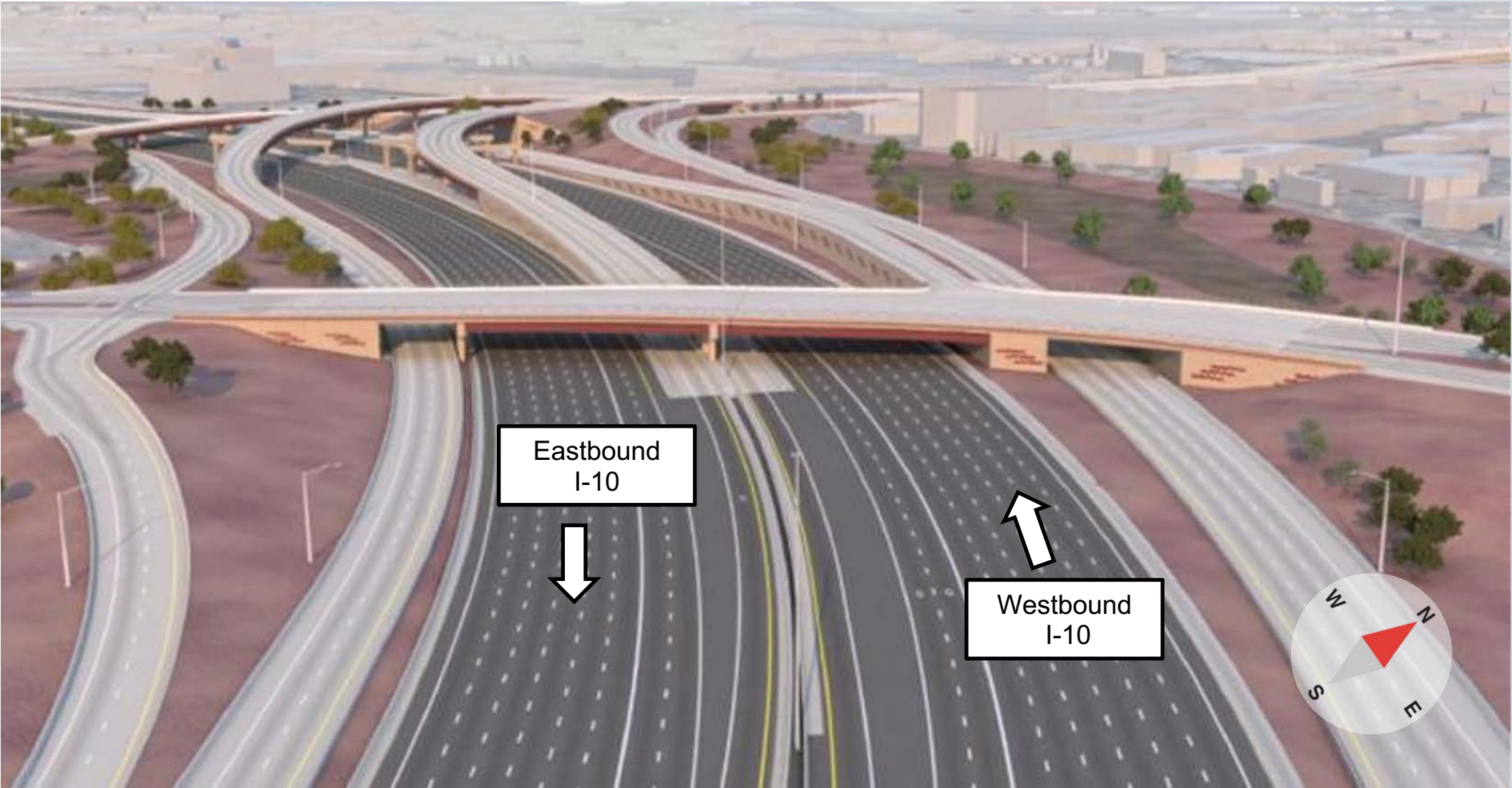



SR 143 Interchange Today



Arizona Department
of Transportation



Future SR 143 Interchange

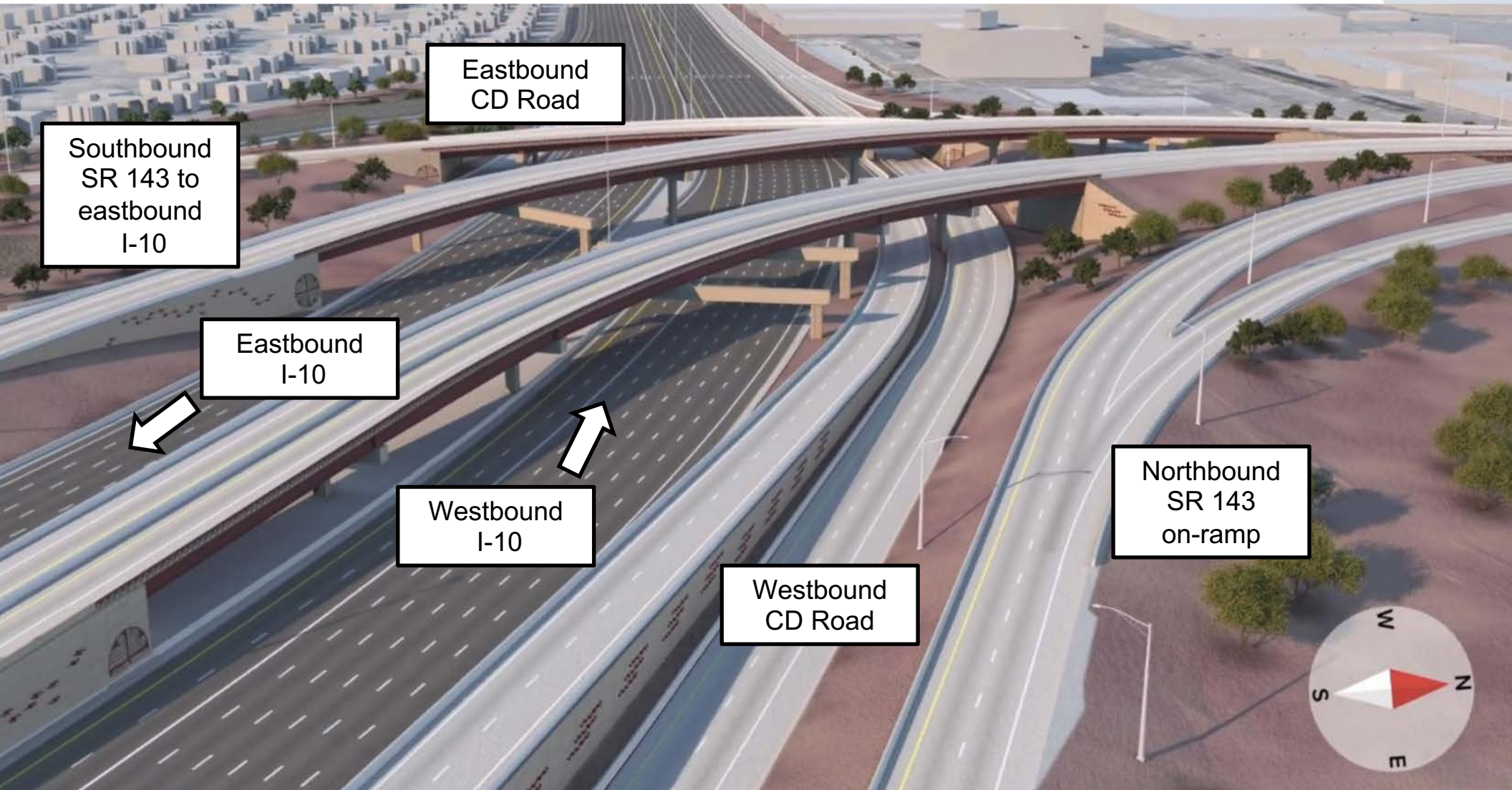



48th Street Bridges Today



Arizona Department
of Transportation



Future 48th Street Bridges

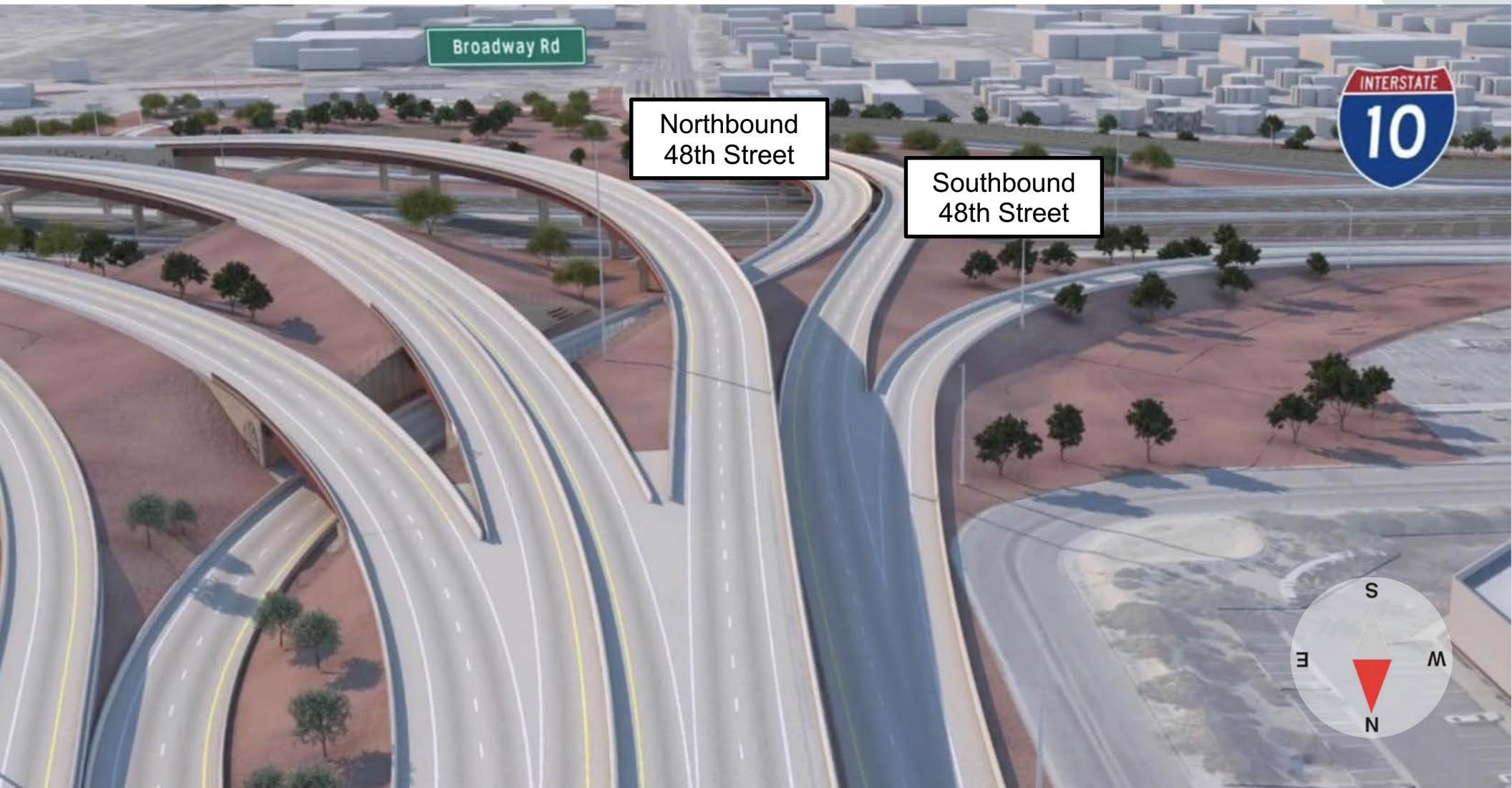

Arizona Department
of Transportation



Bridges Over Salt River Today

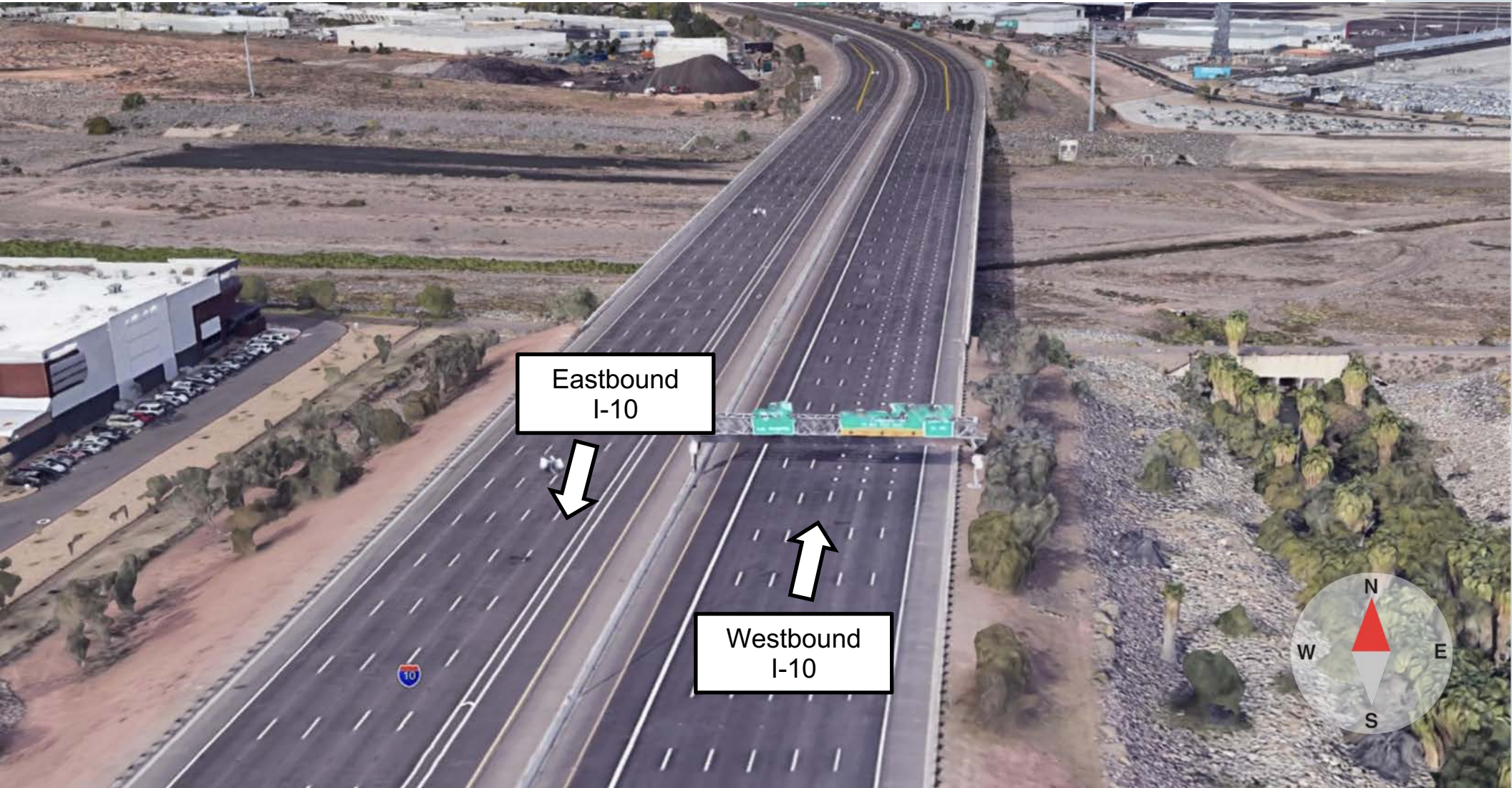



Future Bridges Over Salt River



Arizona Department
of Transportation

Progress





Innovative Approach



Arizona Department
of Transportation

Innovative Approach

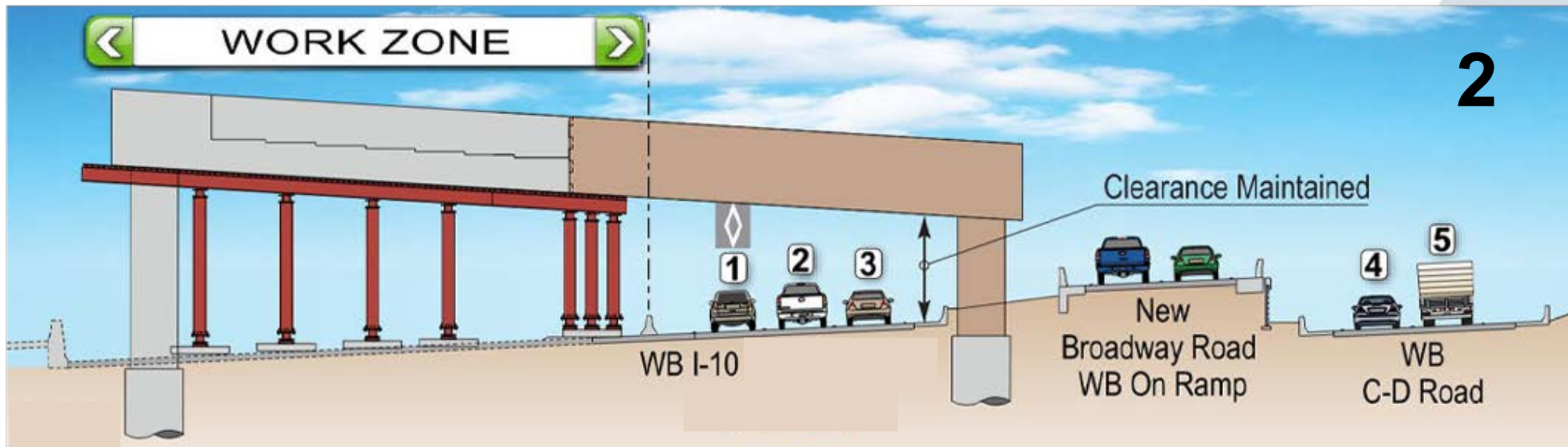
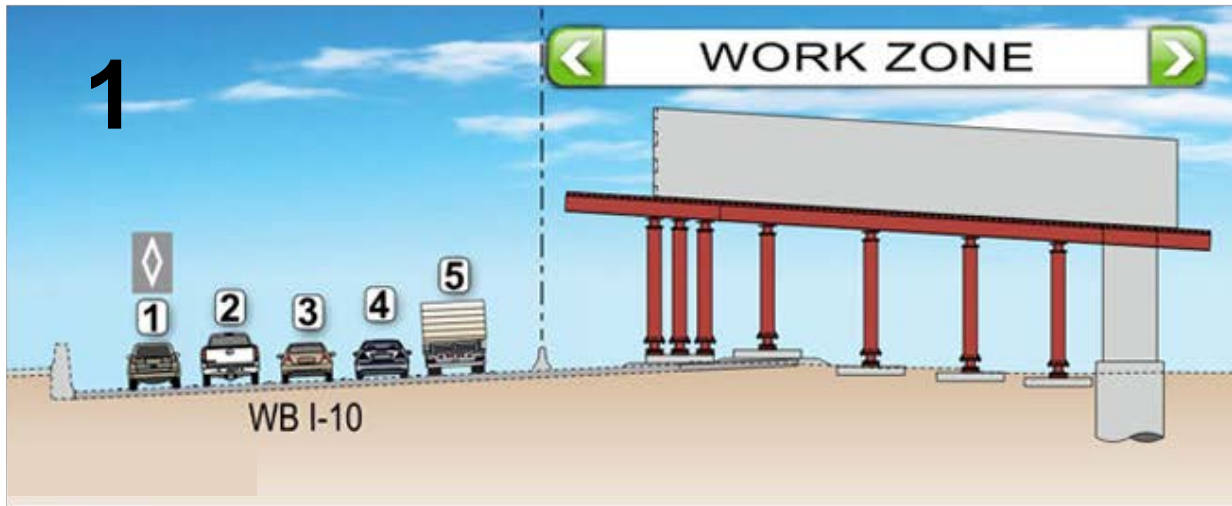



Schedule

2021-2024
Design and Construction

Phase 1
August - Mid-2022

Remove asphalt
Establish work zones
Utility relocations
Roadway improvements
Add bridges at 48th Street
Add bridge at Broadway Road
New lighting

Phase 2
Mid-2022 - Late 2023

Roadway improvement
Ramp reconfiguration
New walls
Widening of roadway
CD roads
Bridge widening
New bridges



Arizona Department
of Transportation



Schedule

Phase 3
Late 2023 - Summer 2024

Complete CD roads
SR 143 to I-10 direct connections

Phase 4
Summer 2024 - Late 2024

Finalize lighting
Finalize signage
Install landscaping
Final roadway surface
Striping
Completion



Stay Informed

i10BroadwayCurve.com

Project
Information
Line 602.501.5505



Info@i10BroadwayCurve.com



ADOT

Arizona Department
of Transportation



Community Office

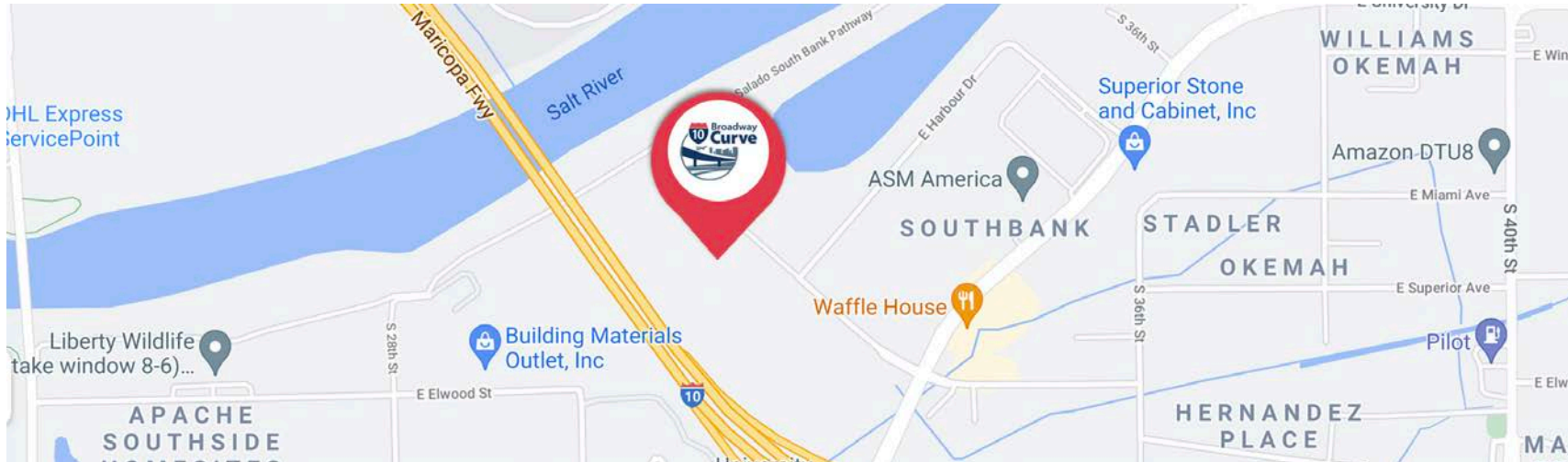

Located at:

- 3157 E. Elwood St., Suite 100,
Phoenix 85034
- Office hours: 8 a.m. to 5 p.m.,
Monday - Friday



Arizona Department
of Transportation



Free Mobile App

Stay #AheadoftheCurve

Download
"The Curve"
Mobile App



GET IT ON
Google Play



Download on the
App Store



ADOT

Arizona Department
of Transportation



Q&A

Ways to ask a question or make a comment tonight:

- For those **online** joining us via WebEx:
 - Use the Q&A function for written comments.
- For those on the **phone** joining us via Tele-Town Hall:
 - Press 0 to indicate you would like to speak.



Website

i10BroadwayCurve.com

Visit OpenBooks Ombudsman-Citizens Aide Get the facts on COVID-19

Search AZ.Gov



LEARN

ALERTS

RESOURCES

OUTREACH

NEWSROOM

CONTACT

Contact Us

Info For

Subcontractors &

Vendors

How To Contact Us

Questions or Comments About the Project?

Name

Email

Comment

PROJECT HOTLINE AND OFFICE

Please call us on our bilingual project hotline at 602.501.5505 or stop by and see us during regular business hours Monday through Friday, between 8 a.m. and 5 p.m., at [3157 E. Elwood St., Suite 100, Phoenix, Ariz. 85034.](#)

REQUEST A SPEAKER

Interested in a member of the project team providing information to your group, organization or event?

Use the comment box to the left and send us your request!



ADOT

Arizona Department
of Transportation



Thank you
#StayAheadOfTheCurve



Arizona Department
of Transportation