

TRAFFIC CONTROL REQUIREMENTS

In any circumstance where you may be affecting the normal flow of traffic, you will be required to provide a traffic control plan (TCP) that conforms to the requirements of the [Manual on Uniform Traffic Control Devices](#) (MUTCD).

A certified traffic control company can assist you with the TCP and in most cases can provide the appropriate devices to set up traffic control. The applicant/permittee is responsible for all costs related to these services. Depending upon the type or extent of traffic control; Department of Public Safety (DPS) Troopers may also be required. In order to schedule DPS Troopers, contact DPS directly at 602.679.5561 or 602.679.5991 or use a third party broker. A list of third party brokers is included in this document.

To find a local traffic control company in the area where you plan to film, you can enter “traffic control company” with the city where you plan to film into a web based search engine. ADOT does not endorse any specific company for these services. The traffic control company that you choose must have at least the state minimum required insurance limits in order to provide services on ADOT controlled roadways. The traffic control company you use may be required to supply proof of required insurance if they do not already have it on file with ADOT Risk Management.

SUBMITTING TCP TO ADOT FOR A FILM PERMIT:

Once the TCP has been developed, it can be submitted to ADOT. If you have already submitted the State Highway Film Application, please note Film Permit and the name of the applicant/project when submitting your TCP. ADOT will review your plan and respond with comments or provide approval.

An example TCP is included at the end of this document. **A TCP is required for partial closures, full closures, rolling blockade and any signage that may be required for your filming activity.**

The following information must be included on the TCP: cardinal direction/legend, correct name of route (SR, US, I and/or street names), mileposts, posted speed, distance between signs (as applicable), distance between flaggers/DPS Troopers (as applicable), distance between vehicles (rolling block), company name, drawn by, company contact information, sign sizes, name of TCP, location, type of set up, start date, end date, times and name of filming activity. Include intermittent traffic delay (ITC) durations and Variable Message Sign (VMS) positions as applicable.

If you have questions, contact Susan Austin at saustin@azdot.gov or 602-712-4142.

TCP EXAMPLE

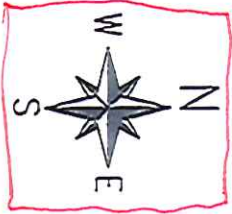

This is only an example-
distances/size/locations must follow
requirements of the current MUTCD.

REVISION:	A
REV DATE:	XX/XX/XX
POSTED SPEED LIMIT	40

NOTE: DISTANCE BETWEEN FLAGGER STATIONS
NOT TO EXCEED 1 MILE.

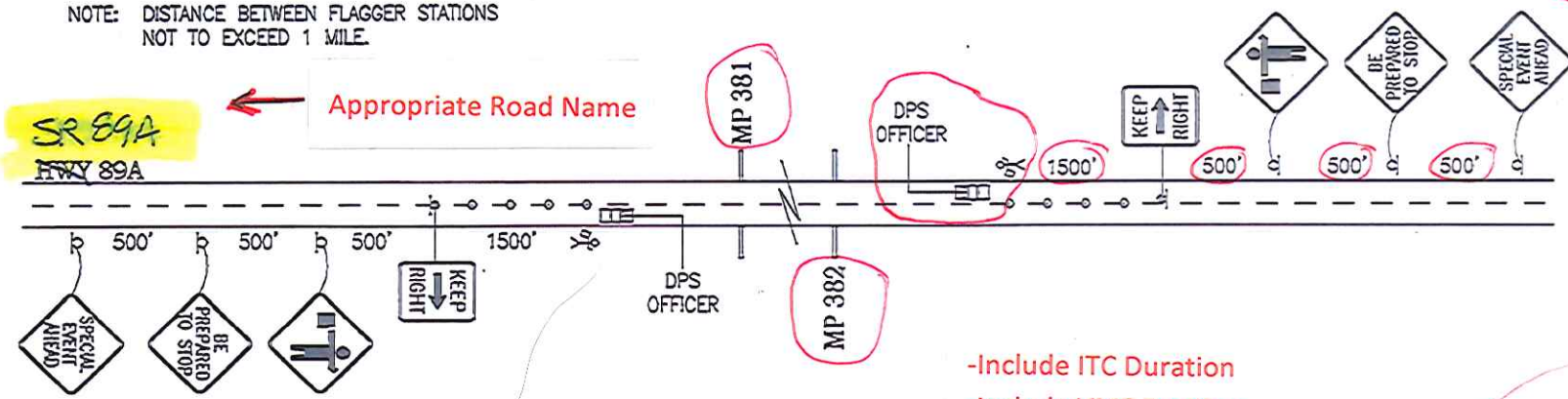

-Include ITC Duration
-Include VMS Position

LEGEND	
	=ARROWBOARD
	=HIGH-LEVEL
	=SIGN STAND
	=VERTICAL PANEL
	=CONE
	=TYPE-1
	=TYPE-2
	=TYPE-3
	=EXISTING

TCP APPROVED BY: _____ DATE: _____

COMPANY NAME	General Operations Manager:	NOTES: PLAN IS NOT TO SCALE. This is a winter and/or protection plan only. Protection access shall be maintained if possible. All applicable equipment shall have sandbags and flags. This traffic control plan is for day and/or night time use. Business and local traffic shall be maintained when possible. Ramp signs shall be placed in front of ALL steel plates in the roadway. Conflicting existing signs shall be covered for temporary traffic control. Equipment list is approximate, plan is subject to changes made in the field.	TCP NAME: 021015-001	CONTRACTOR:
DRAWN BY: TECH THAT DREW PLAN	Office: CONTACT #'S FOR TC COMPANY		MUNICIPAL: ADOT	PRODUCTION (FILM ACTIVITY) NAME
Reviewed by: _____ -Action Employee-	TCP Fax: Dispatch: 24 Hours:		LOCATION: HWY 89A & MP 381 - 382	CONTACT NAME: PRODUCTION CONTACT NAME
	SIGN SIZE: 48"X48" X 36"X36"		TYPE OF SET-UP: FLAGGER STATIONS	CONTRACTOR'S NUMBER: CONTACT #
			START DATE: 02/23/15 END DATE: 02/23/15	CONTRACTOR'S FAX: X
				WORK HOURS: 0700-1700

THIRD PARTY BROKERS

<p>AZ Police Traffic Services** P.O. Box 5847 Peoria, AZ 85385 Phone: (623) 566-1332</p>
<p>Extra Duty LLC 207 N. Gilbert Rd. Ste. 207 Gilbert, AZ 85234 Phone: (877) 606-1212</p>
<p>Law Enforcement Specialist, Inc. P. O. Box 11656 Glendale, AZ 85318 Phone: (623) 825-6700</p>
<p>Professional Police Services, Inc. 1009 E. Carlise Rd. Phoenix, AZ 85086 Phone: (623) 465-8878</p>
<p>Pro-Force LLC 6206 E. Northern Ave. Paradise Valley, AZ 85253 Phone: (623) 582-1888</p>
<p>Right Choice P. O. Box 10637 Glendale, AZ 85318 Phone: (623) 334-2740</p>
<p>Shumway Security 12235 E. Triple T Lane Prescott Valley, AZ 86315 Phone: (928) 772-7075</p>
<p>Special Assignments Group 3030 W. Peoria Ave. Phoenix, AZ 85029 Phone: (602) 320-8917</p>
<p>Valley Police Specialists 16247 N. 137th Dr. Surprise, AZ 85374 Phone: (602) 526-2349</p>

**EZ Pay Account